



world yacht group

Experts in luxury yachts

Esmeralda of the seas



LOA:	96' (29.26m)	Delivery/Model	2018
Beam:	22' 10" (6.94m)	Year:	
Max Draft:	6' 11" (2.1m)	Model:	MCY 96
Tonnage:	119.00	Builder:	MONTE CARLO YACHTS
Speed:	20 Knots 26 Knots	Type:	Motor Yacht Semi-Displacement
Flag:	MALTA	Staterooms:	5
Location:	Toulon, Provence-Alpes- Cote-d'Azur France	Fuel Cap:	18000 L (4755.1 Gal)
VAT Paid:	VAT Unpaid	Water Cap:	1650 L (435.88 Gal)
		Engines:	2x, MTU, 16V 2000 M 86, 2200 HP
		Price:	(\$6,694,043 USD est.) €5,950,000 EUR

Generated On 5/11/2025 3:54 PM by WORLD YACHT GROUP SVC Account

WORLD YACHT GROUP USA

WORLD YACHT GROUP SVC

Esmeralda of the seas

Account

**info160920210306@world-yacht-
group.com**

worldyachtgroup.com

Page 1 of 21

Additional Specifications For Esmeralda of the seas:

LOA:	96' (29.26m)	Delivery/Model	2018
Beam:	22' 10" (6.94m)	Year:	
Min Draft:	6' 11" (2.1m)	Year Built:	2018
Max Draft:	6' 11" (2.1m)	Refit Year:	2021
Hull Material:	Carbon Composite	Builder:	MONTE CARLO YACHTS
Superstructure:	GRP	Model:	MCY 96
Hull Config:	Planing	Type:	Motor Yacht Semi-Displacement
Hull Designer:	NUVOLARI LENARD	Engines:	2200 HP,Twin, 2017, Inboard, Diesel, MTU, 16V 2000 M 86, 1272hrs / 1272hrs
Deck Material:	Teak	Staterooms:	5
Tonnage:	119.00	Sleeps:	11
Range At Cruise	1100	Heads:	5
Speed:		Crew Quarters:	1
Range At Max		Captain Cabin:	Yes
Speed:	Cruising 20 Knots	Classifications:	RINA Rina hull and machinery
	Max 26 Knots	MCA: Yes	ISM:
Ext Designer:	NUVOLARI LENARD		
Fuel Capacity:	18000 L (4755.1 Gal)		
Water Capacity:	1650 L (435.88 Gal)		
Holding Tank:	1600 L (422.68 Gal)		
Flag:	MALTA		
Location:	Toulon, Provence-Alpes-Cote- d'Azur France		
Price:	(\$6,694,043 USD est.) €5,950,000 EUR		
Tax Status:	VAT Unpaid		

Boat Highlights

OVERVIEW

Launched in 2018, 29.5m Esmeralda of the Seas is an exceptional example of cutting edge technology, sophisticated materials and contemporary luxury working in harmony with her surroundings.

Designed with particular attention given to reducing her environmental impact; next generation engines offer low fuel consumption whilst the specialist onboard water treatment system minimizes the effects on marine life. Organic and ecological products used on board further protects the ocean that she cruises.

Winner of numerous awards including 'Most Achieved Boat' at Cannes Boat Show 2018, Esmeralda of the Seas exceptional space over 3 decks featuring five beautifully-appointed cabins including master suite on the main deck and four cabins below-deck. Both twin cabins are convertible allowing flexible accommodation of up to five doubles. Interiors are light and airy whilst exteriors offer numerous seating, dining and sunbathing spaces.

Esmeralda of the Seas also boasts both stabilizers at anchor and underway, a custom-made Jacuzzi as well as a plethora of toys.

KEY FEATURES

- Custom made Jacuzzi
- Tropical A/C
- Large flybridge
- Successful charter yachts
- Long range capacity
- Hydraulic swim platform

CLASS / REGULATIONS

- Flag: Malta
- Registry: Commercial
- Classification: RINA
- IMO nbr: 9843704
- MMSI nbr: 9HB5885
- Official nbr: 18082
- HIN: ITMCY 96002 L718, CE cat A

MAIN CHARACTERISTICS

Generated On 5/11/2025 3:54 PM by WORLD YACHT GROUP SVC Account

WORLD YACHT GROUP USA

WORLD YACHT GROUP SVC

Esmeralda of the seas

Account

**info160920210306@world-yacht-
group.com**

worldyachtgroup.com

Page 3 of 21

- Name: Esmeralda of The Seas
- Price: 7 850 000€
- Tax status: Not Paid
- Type of hull: Planing
- Model: MCY 96
- Builder: Monte Carlo Yachts
- Hull nbr: 002
- Naval architect: Monte Carlo Yachts
- Interior designer: Nuvolari Lenard
- Exterior designer: Nuvolari Lenard
- Year: 2018
- Refit: 2020
- Hull material: Carbon Composite
- Superstructure material: GRP
- Cabins: 5 for 11 sleeping guests
- Crew: 5

DIMENSIONS

- LOA: 29,5m - 96ft
- LWL: 23,98m - 79ft
- Beam: 6,94m - 23ft
- Draft: 2,1m - 6ft
- Air draft: 9,2m - 30ft
- Gross Tonnage: 119
- Net Tonnage: 119
- Displacement (full): 110 T
- Displacement (half): 98 T

SPEED / RANGE

Generated On 5/11/2025 3:54 PM by WORLD YACHT GROUP SVC Account

WORLD YACHT GROUP USA

WORLD YACHT GROUP SVC

Esmeralda of the seas

Account

**info160920210306@world-yacht-
group.com
worldyachtgroup.com**

Page 4 of 21

- Cruising: 20 knt - 2200 rpm - 560 L/H - 70% load - 650 nm
- Max: 24 knt - 2800 rpm - 840 L/H - 98% load - 514 nm
- Eco: 10 knt - 1000 rpm - 100 L/H - 30% load - 1800 nm

CAPACITY

- Fuel: 18 000 L - 2906 US gal (GRP) "Extended from 11 000L standard"
- Fresh water: 1650 L - 436 US gal (GRP)
- Grey water: 1000 L - 264 US gal (GRP)
- Black water: 600 L - 158 US gal (GRP)
- Dirty oil: 100 L - 26 US gal (stainless steel)

NAVIGATION

- ECDIS: Raymarine electronic plotter
- AIS: Raymarine AIS 650
- Auto pilot: Raymarine P70R
- Gyro compass: Raymarine
- Magnetic compass: Ritchie F-83
- Radars: Raymarine
- GPS: 2x screens 15" Raymarine GS165
- Navtex: JRC NCR-333
- Echo sounder: Raymarine
- Depth sounder: Raymarine DST800 Depth
- Control panel: Boning AHD 1119GS 19"
- Anemometer: Raymarine
- VHF: Furuno FM-8900S
- SART: RIKS 701
- EPIRB: GMDSS Cat1 MT403FF-e999J
- SAT-C: Furuno Felcom18

SAFETY

- Liferaft: 3x DeepSea SOLAS B, 10pax each
- Lifejacket: 24x SOLAS adult, 4x Children SOLAS
- Lifering: 4
- Flares: 4x para, 4x red handheld, 2x Orange Smoke
- Fixed Fire extinguisher: Engine room FM200 with alarms and auto shutdown
- Handheld Fire extinguisher: 18x 1Kg powder, 1x 9L Foam, 3x 4,5Kg Powder
- Fire blanket: 1x In galley
- Fire pumps: Gianneschi 150L/minutes
- Smoke detectors: In every location
- Heat detector: Galley
- Fire damper: In garage

ACCOMODATIONS

5 staterooms for 11 sleeping guests.

- **Master:** 22 sqm, King size bed with memory foam mattress, electrical Roman curtains, 46"TV, ensuite bathroom with stone floor and hydro-massage shower, plain oak floor throughout the cabin, walk-in closet. 70dB during cruise speed, 45dB at anchor with generators.
- **2x Vip:** 12 sqm, Queen size bed with memory foam mattress, vanity desk, plain oak floor, 75dB at cruise speed and 55dB at anchor with generators.
- **2x Twin:** 11 sqm, 60x190cm bed Possible to merge to create a single. TV LG Led 28", Manual curtains.
- **Crew:** 3x cabins for 2 bunk beds with TV and 1x captain cabin. Alarm repeater in crew mess, captain cabin + screen control and CCTV screens.
- **Salon:** 60 sqm, Sofa, Dining table for 10, LCD TV 50", electrical venetian curtains, 75dB at cruise speed and 55dB at anchors with generators.
- **Flybridge:** 70 sqm, Leather pilot seatings, leather steering wheel.

DECK EQUIPMENTS

Generated On 5/11/2025 3:54 PM by WORLD YACHT GROUP SVC Account

WORLD YACHT GROUP USA

WORLD YACHT GROUP SVC

Esmeralda of the seas

Account

**info160920210306@world-yacht-
group.com**

worldyachtgroup.com

Page 6 of 21

- Anchors: 2x 136Kg PTW, steel, Duplex®
- Anchor chains: 2x 150m x14mm
- Windlass: 2x electric 3Kw 400V AC, Maxwell 4500
- Winch: 2x 3Kw 24V electric, Maxwell 4500
- Passerelle: Opacmare 150kg SWL
- Mooring lines: 5x 20mx24mm, 1x 25mx24mm
- Cleats: 12x Stainless Steel
- Fenders: 8x F7 with MCY covers (380mmx1040mm), 2x A4 with MCY covers (550mmx710mm)
- Paint: Gelcoat white superstructure, Pearl white hull, Grey domes and side mast supports, Grey carbon fiber T-Top
- Teak: 22 mm

AV / IT

- TV: Sat KVH TV8
- Control System: Boning
- CCTV: 2x in Engine room, 1x in control room, 1x cockpit aft, 1x swimming platform
- 4G/5G antennas: Digital Yacht 4G connect
- Sound: Sonos throughout the yacht
- Computers: Asus Vivo 14"
- Printers: Epson XP-452

GALLEY / LAUNDRY

- Fridges: Miele K37473 ID 300L
- Freezer: MIELE FNS37402I 200L
- Microwave: SHARP R200BKW, 800W
- Dishwasher: MIELE JUBILEE SC
- Washing machine: MIELE WMH122 WPS 9Kg
- Dryer: MIELE WMH122 WPS
- Wine Cellar: MIELE KWT6321UG
- Oven: MIELE H6290B
- Hobs: Induction Miele KM 6340, 76cmx50cm, 7,4Kw, 230V 50-60Hz
- Ice Machine: 2x Vitrifrigo
- Coffee machine: 2x Nespresso Delonghi

TENDERS & TOYS

- Tender: Williams jet 445 110HP, hydraulic swim platform (1600Kg max load)
- Seabobs: 2x FS5
- 3x Paddle boards
- 1x Kayak + 1x Wakeboard

MECHANICAL

Generated On 5/11/2025 3:54 PM by WORLD YACHT GROUP SVC Account

WORLD YACHT GROUP USA

WORLD YACHT GROUP SVC
Account
info160920210306@world-yacht-
group.com
worldyachtgroup.com

Esmeralda of the seas

- Engines: 2x MTU 16V 2200HP M86 Diesel - 1559 Hours
- Generators: 2x 45Kw Kohler 400V AC, 50Hz - 3730 Hours
- Bow thruster: Hydraulic, 40HP, Sidepower SH550
- Stern thruster: Hydraulic, 40HP, Sidepower SH550
- Stabilizers: Anchor & underway CMC SE80 - SE120
- Trim system (Fast yacht): Electric
- Gearbox: ZF 3060V 10°V
- Shaft: Aquamet 22, 105mm
- Propellers: 5xBlades NiAl-Alloy
- Steering system: Power assisted, Reverse Gear Electronic
- Electrical: ASEA System 110/220V 50/60Hz
- Rudder: AISI 316 Steel
- Shore power: 125A 2x cables
- Batteries: 2x 225Amp 12V, 15x 160Amp 12V, 4x 130Amp 12V (New 2021/2022)
- Chargers: 2x24V 80Amp, 4x24V 30Amp, 1x12V 35Amp
- Inverters: 110V / 220V
- Transformer: ASEA for US/EU 75Kw, in 170-520V AC 40-75Hz, ou 230/400V 50Hz
- Oil water separator: Alfa Laval MIB 303
- Sewage treatment: HAMANN HL-CONT 0125, 450L, IMO standard
- Flushing system: Tecma Electrical
- Fuel treatment: Alfa Laval MIB 303, 760L/h
- Air conditioning: Tropical option Reverse cycle Climma® (New 2021)
- Water maker: 1x Searecovery 280L/h
- Boiler: QUICK 2x 80L, QUICK 1x 160L
- Air compressor: CLIMMA CWS DC130
- Bilge pump: 6x 24V auto
- Bilge alarms system: Level and sound indicator + repeater

REFIT / SERVICE / MAINTENANCE

- New Hull Paint by Monte Carlo (2021)
- Superstructure Polished (2021)
- MTU engines yearly maintenance
- Generator yearly maintenance
- Water cut bearings changed in 2021
- Antifouling spray every year
- Packing glands changed 2021
- New electrical engine for windlass 2021
- Shaft & propellers inspected in 2021
- Stabilizers inspected in 2021

The 2021 yard maintenance happened in Monte Carlo Yachts facility in Montefalcone, Italy and was done for the majority by the builder workforce.

WORLD YACHT GROUP USA

WORLD YACHT GROUP SVC

Esmeralda of the seas

Account

info160920210306@world-yacht-
group.com

worldyachtgroup.com

At sea



At sea



Generated On 5/11/2025 3:54 PM by WORLD YACHT GROUP SVC Account

WORLD YACHT GROUP USA

WORLD YACHT GROUP SVC

Esmeralda of the seas

Account

**info160920210306@world-yacht-
group.com**

worldyachtgroup.com

At sea



Saloon



Dining with balcony



Master Cabin

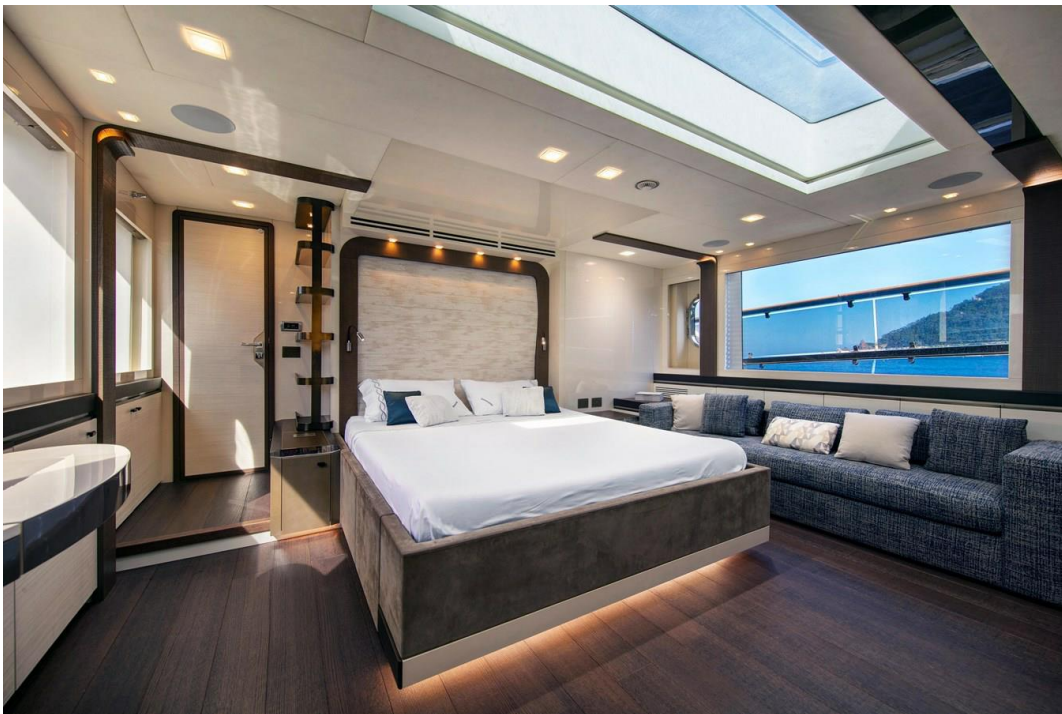

0X2A9720-min



Master bathroom



Guest port side



VIP Starbord



VIP bathroom



Guest Starbord



Guest Bathroom



Aft deck



Fly



Fly



Generated On 5/11/2025 3:54 PM by WORLD YACHT GROUP SVC Account

WORLD YACHT GROUP USA

WORLD YACHT GROUP SVC

Esmeralda of the seas

Account

**info160920210306@world-yacht-
group.com**

worldyachtgroup.com

Page 17 of 21

Fly



Fly



Generated On 5/11/2025 3:54 PM by WORLD YACHT GROUP SVC Account

WORLD YACHT GROUP USA

WORLD YACHT GROUP SVC

Esmeralda of the seas

Account

**info160920210306@world-yacht-
group.com**

worldyachtgroup.com

Page 18 of 21

Front Deck



Generated On 5/11/2025 3:54 PM by WORLD YACHT GROUP SVC Account

WORLD YACHT GROUP USA

WORLD YACHT GROUP SVC

Esmeralda of the seas

Account

**info160920210306@world-yacht-
group.com**

worldyachtgroup.com

Page 19 of 21

Maindeck-PilotHouse

Main Deck & Pilot House **ESMERALDA OF THE SEAS**

WcY96

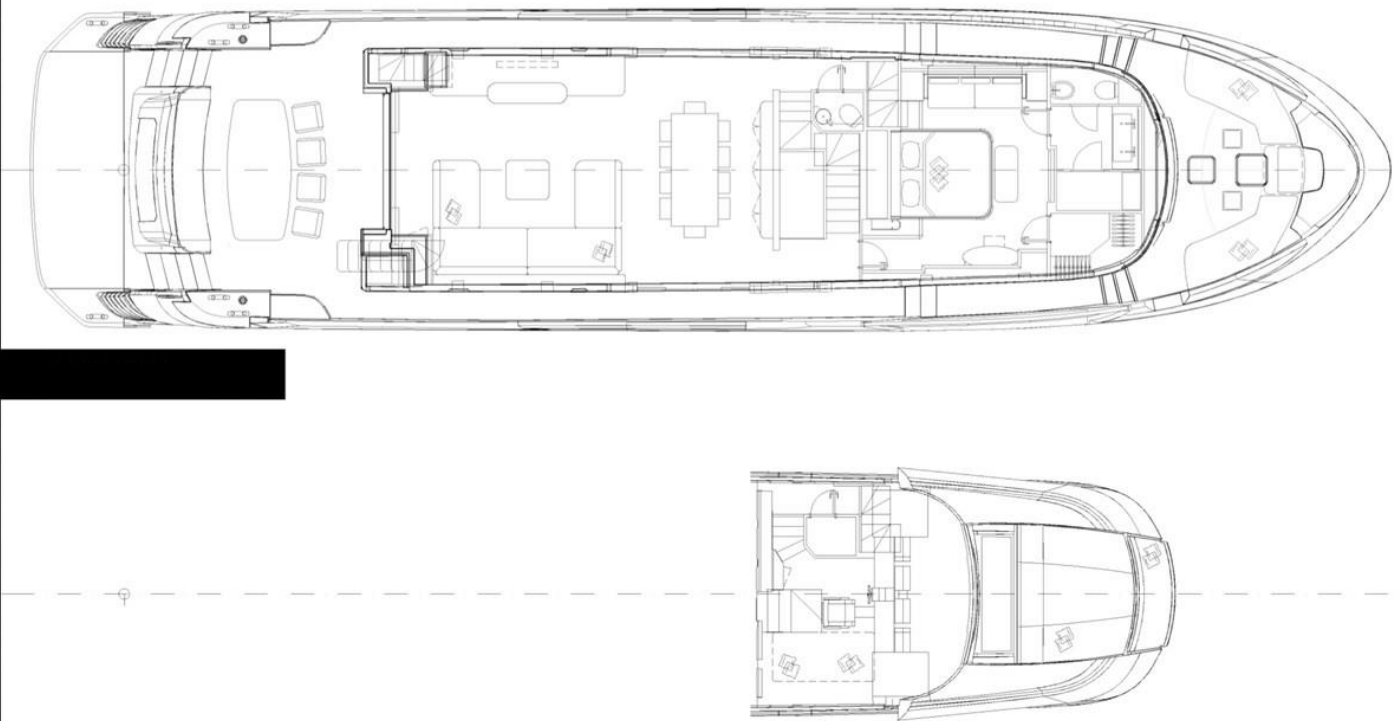

WcY

MONTECARLO YACHTS

Generated On 5/11/2025 3:54 PM by WORLD YACHT GROUP SVC Account

WORLD YACHT GROUP USA

WORLD YACHT GROUP SVC

Esmeralda of the seas

Account

**info160920210306@world-yacht-
group.com**

worldyachtgroup.com

Page 20 of 21

Lower-Deck

Lower Deck

ESMERALDA OF THE SEAS

MCY96

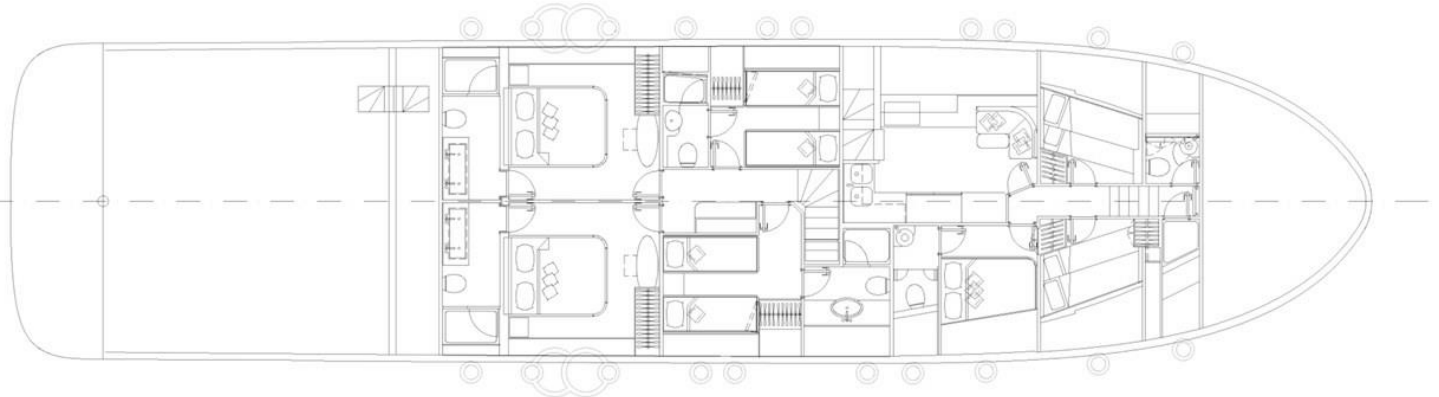

MONTECARLOYACHTS

Generated On 5/11/2025 3:54 PM by WORLD YACHT GROUP SVC Account

WORLD YACHT GROUP USA

WORLD YACHT GROUP SVC

Esmeralda of the seas

Account

**info160920210306@world-yacht-
group.com**

worldyachtgroup.com

Page 21 of 21