



OVERVIEW



TYPE	Sail	DESIGNER	Design Unlimited
LENGTH	85' (25.91m)	SPEED	12 Knots
BEAM	20' 5" (6.2m)	ENGINES	1x, Yanmar, 4JH80, 80 HP
DRAFT	15' (4.57m)	RANGE	400
BUILDER	MC CONAGHY	FLAG	N/A
HULL MATERIAL	Composite	TAXES PAID	N/A

ASKING PRICE POA

TJB SUPER YACHTS LTD SVC ACCOUNT M: T: E: INFO120120220343@TJB-SUPER-YACHTS-LTD.COM

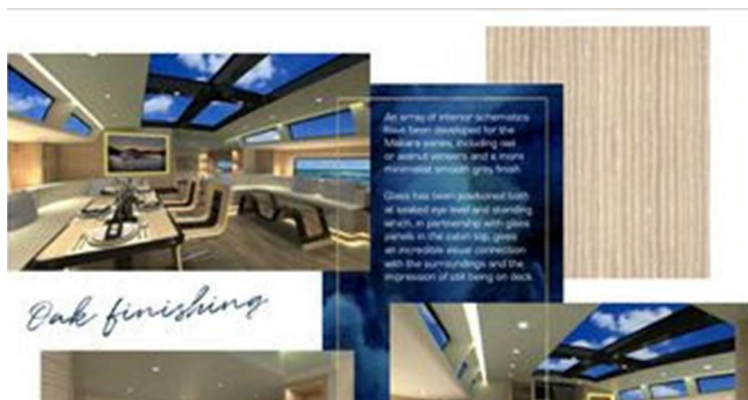



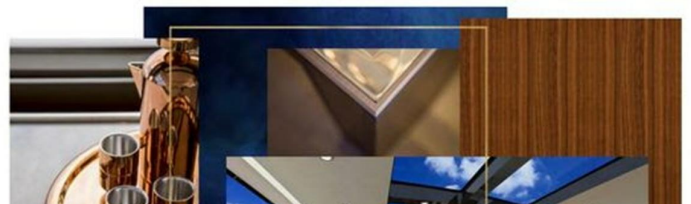

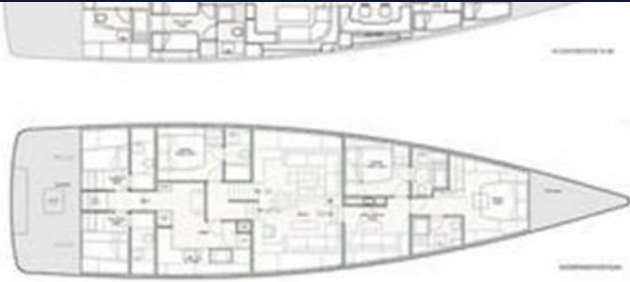

*Walnut finishing*



## DETAILED SPECIFICATIONS



### MAIN CHARACTERISTICS

TYPE	SAIL
COUNTRY OF REGISTRY	N/A
PORT OF REGISTRY BUILT	2023
REFIT	N/A
BUILDER	MC CONAGHY
NAVAL ARCHITECH	N/A
EXTERIOR DESIGNER	N/A
INTERIOR DESIGNER	DESIGN UNLIMITED
LWL	85' 11" (26.19M)
BEAM	20' 5" (6.2M)
MAX DRAFT	15' (4.57M)
CONSTRUCTION	N/A
HELIDECKS/HANGER	N/A

## Description

### 2023 McConaghy Makara

**MAKARA LUXURY SUPER SAILING YACHT** The series comprises the Makara 85, Makara 105 and the Makara 120. The exterior lines incorporate a defined hull chine and low profile superstructure, with dark glass giving a dynamic and striking contrast to the teak deck and paintwork.

Benefitting from the full scope of McConaghy's experience in the build of high-performance carbon fibre race boats, the Makara is a lightweight luxury yacht series, which brings the superyacht lifestyle to the racecourse in a way never seen before.

The Makara series has been designed by Malcolm McKeon, and Pure Design have been engaged for the composite engineering. In bringing this design to the market place, the team set out to devise a monohull that whilst able to comfortably accommodate a family, can be sailed and raced short-handed.

Constructed using prepreg carbon and structural foam cores, the 25.9m model has a lightship displacement of just 48 tonnes. The rig package for the Makara series has been specified by Southern Spars, and a client can hone their racing and cruising preferences with the optional additions of a bowsprit and a lifting keel.

The sail plan for the Makara 85 features a 189sq.m mainsail and a 149sq.m blade. The mainsheet trim comes with push-button functionality, thanks to an in-boom hydraulic ram and a hydraulic press system serving the blade. This level of control offered to the helmsman brings single-handed sailing capability to the yachting mass-market place in an incredibly beautiful package. Mainsail Area - 2, 034 Feet Furling Jib - 1,603.82 Feet Semi-Custom Design Model options are from 85' to 120'

## Disclaimer

The company offers the details of this vessel in good faith but cannot guarantee or warrant the accuracy of this information nor warrant the condition of the vessel. A buyer should instruct their agents, or their surveyors, to investigate such details as the buyer desires validated. This vessel is offered subject to prior sale, price change, withdrawal without notice, and tax when applicable.



2023 McConaghy Makara



# 2023 McConaghy Makara

+44 (0) 207 183 4393 • [ENQUIRIES@TJBSUPERYACHTS.COM](mailto:ENQUIRIES@TJBSUPERYACHTS.COM)

24.11 CODA STUDIOS, 189 MUNSTER ROAD, FULHAM, LONDON, SW6 6AW, UK