



OVERVIEW

TYPE	Motor	DESIGNER	Espinosa Inc
LENGTH	100' 1" (30.5m)	SPEED	10 Knots
BEAM	25' 11" (7.9m)	ENGINES	1x, Caterpillar, C18 Acert, 715 HP
DRAFT	7' 11" (2.41m)	RANGE	7000
BUILDER	ALL OCEAN YACHTS	FLAG	N/A
HULL MATERIAL	Composite Fiberglass	TAXES PAID	No Duty Paid



All Ocean Yachts Overing 100' Explorer

ASKING PRICE \$9,195,000 USD

TJB SUPER YACHTS LTD SVC ACCOUNT M: T: E: INFO120120220343@TJB-SUPER-YACHTS-LTD.COM

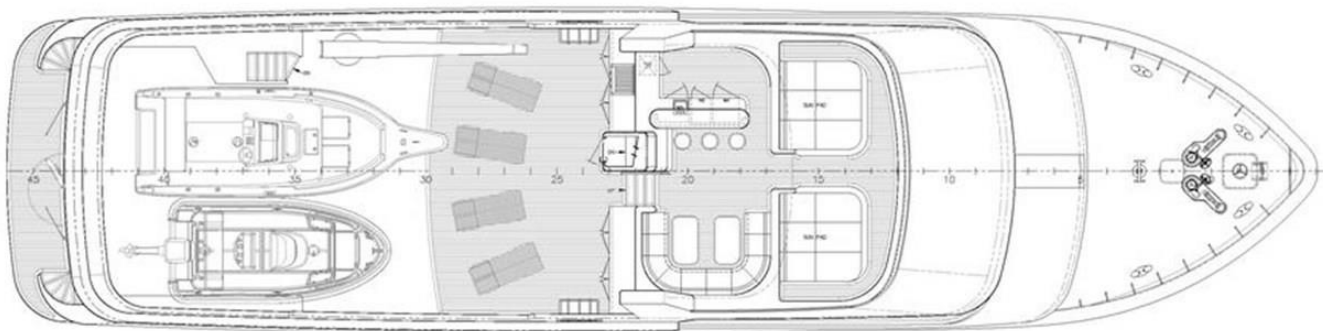

01 DECK & FLYBRIDGE

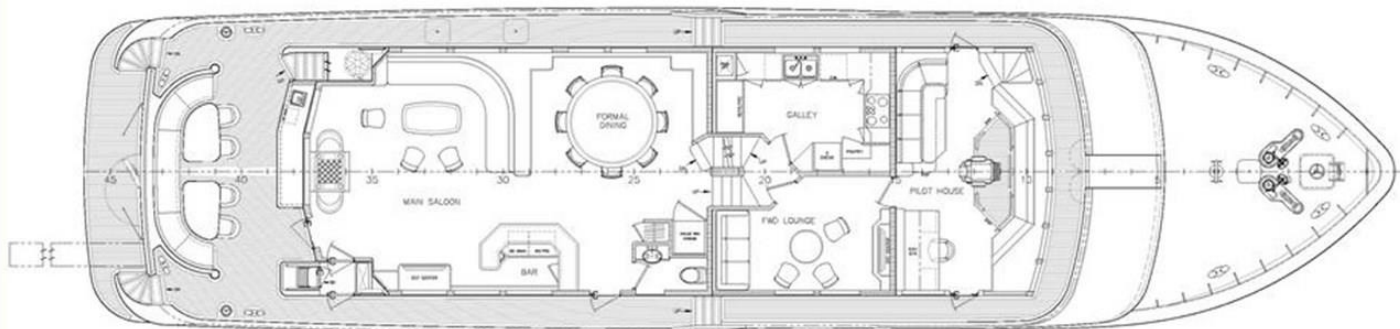

MAIN DECK

DAUNTLESS

The Explorer's EXPLORER[®]

D100

This drawing, design, contract, and specifications are the exclusive property of OVERING YACHT DESIGNS, LLC. They are to be used only for the purpose of building the yacht as shown and are not to be used for any other purpose. The recipient of this drawing agrees not to change these contents without the written permission of OVERING YACHT DESIGNS, LLC.

SCALE: 1/4" = 1'-0"
DRAWN BY: JPL/CH
DATE: 10/22/2011
DWT BY: JPD
JOB NO.: 5308
REV: 1

100'-0" x 25'-6" x 7'-6"
PILOT HOUSE EXPLORER
GENERAL ARRANGEMENTS

APPROVALS
BYD: _____
OWNER: _____
BUILDER: _____
CLASS: _____

OVERING YACHT DESIGNS, LLC
10171 Old S. 1st Ave., Suite 100
P.O. Box 2010
Web: www.oringyacht.com
INTERNATIONAL YACHT AND SHIP DESIGN SINCE 1969



SUPER YACHTS

All Ocean Yachts Overing 100' Explorer

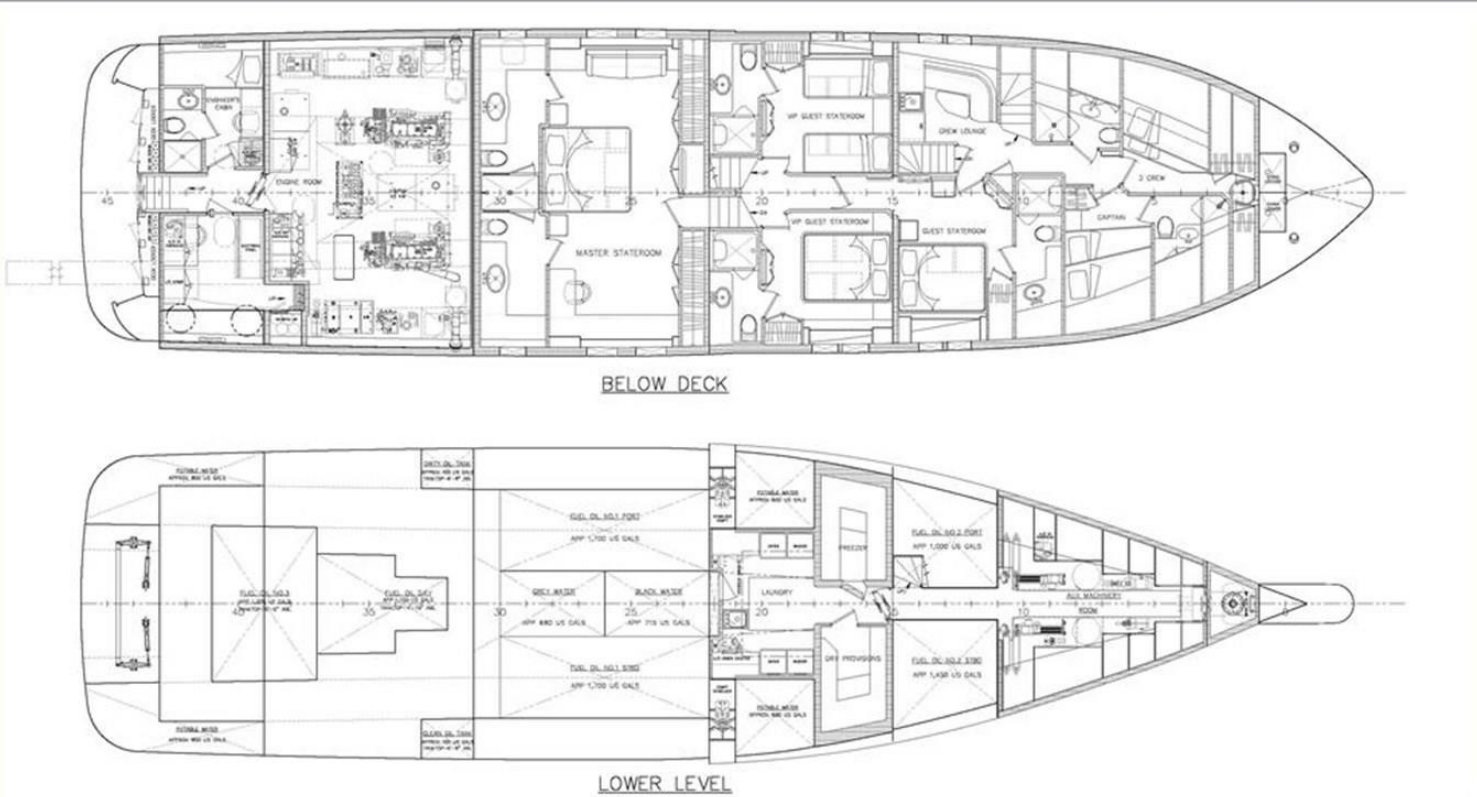

The Explorer's EXPLORER[®]D100

This drawing, design concept, and specifications are the exclusive property of OVERING YACHT DESIGNS, LLC. They are based on a confidential basis with no implied understanding that they will not be copied in any manner, used for manufacturing, with, transferred, or used by the customer or any other person without permission. The customer further agrees not to change these contents herein to any other person without the express written consent of OVERING YACHT DESIGNS, LLC.

SCALE: 1/4" = 1'-0"	DATE: 12/01/11	DOC NO: 001-1
DRAWN BY: JPD	CHKD BY: JPD	REV 1 OF 1
HULL NO:	JOB NO: 1008	REV 1

100'-0" x 25'-6" x 7'-6"
PILOT HOUSE EXPLORER
OUTBOARD PROFILE

APPROVALS	BUILDER
OWNER	CLASS

OVERING YACHT DESIGNS, LLC
1817 OLIVE ST., 7th Floor, Suite 700
PHILADELPHIA, PA 19103
WWW.OVERINGYACHTDESIGNS.COM
INTERNATIONAL YACHT AND SHIP DESIGN SINCE 1969



All Ocean Yachts Overing 100' Explorer

DETAILED SPECIFICATIONS



MAIN CHARACTERISTICS

TYPE	MOTOR
COUNTRY OF REGISTRY	N/A
PORT OF REGISTRY BUILT	2027
REFIT	N/A
BUILDER	ALL OCEAN YACHTS
NAVAL ARCHITECH	N/A
EXTERIOR DESIGNER	OVERING YACHT DESIGN
INTERIOR DESIGNER	ESPINOSA INC
LWL	N/A
BEAM	25' 11" (7.9M)
MAX DRAFT	7' 11" (2.41M)
CLASSIFICATION:	LLOYD'S 100A1 MALTESE
CONSTRUCTION	N/A
HELIDECKS/HANGER	N/A



All Ocean Yachts Overing 100' Explorer

Introduction

The All Ocean Yachts Overing Explorer Yachts are based on the proven high efficiency full displacement hull form created by Overing Yacht Design, a recognized leader in this type of hull. The hull form allows the All Ocean Yachts' Overing line to cruise using very small amounts of fuel and increased speeds for a given RPM. This greatly reduces the overall operating cost of the vessel.

The design was created for worldwide travel and cruising in remote areas with little or no shore support for long periods of time.

The large volume created by the Overing design gives it the room to carry all of the equipment and supplies needed for world cruising.

The volume also allows all of the All Ocean Yachts' Overing design line of yachts to have a very unique feature. They have a full height deck forward below the normal lower accommodations deck. This area is accessed via a door and stairs. This deck contains a nice laundry area, extra refrigerators and freezers and a lot of dry good storage.

Forward of the storage area is a pump room with the fresh water pumps, two water makers, water heaters and water filters. Note there is a third water heater for the crew area.

The exceptional flybridge layout not only has comfortable seating and all of the amenities you would expect but she also carries a larger than normal tender for a vessel of her size.

When compared against other vessels in their size range the All Ocean Yachts' Overing 100' stands out as a serious cruising yacht with exceptional features that few can match.

General Specifications

- LOA 100'-0"
- Beam 25'-6"
- Draft 7'-6"
- Highly Efficient Round Bilge Bulbous Bow Hull
- Displacement 190 LT Approx.
- Fuel Tankage 10,000 gals.
- Water Tankage 1,500 gals.
- Grey Water Tankage 400 gals.
- Black Water Tankage 600 gals.
- Dirty/Lube Oil Tankage 100 gals.
- Naval Architecture & Design: Overing Yacht Designs
- Interior Design: Espinosa Inc. or Owner Choice
- Sound Engineering: Soundown Inc. or Equal

Construction

Solid Laminate Infused Vinylester Hull
Foam Cored Vinylester Infused Superstructure
High Quality Awlgrip Finish
Classed RINA/MCA LY2
Five (5) Watertight Compartments



All Ocean Yachts Overing 100' Explorer

Engine Room & Major Equipment

(2) Cat C18 Acert, 715HP Max Cont "C" Rating
(2) Twin Disc MGX 5114 DC
Twin Disc single lever controls
Custom Water Drop Exhaust System
(2) 55kW Northern Lights Generators w/InSep
Racor Fuel/Water Filters
Alpha Laval Fuel Centrifuge
Fuel Transfer System
Bilge System/Fire Fighting System
Headhunter MSD
Fire Extinguishing System
Hydraulic Bow Thruster
TRAC "STAR"Hydraulic Stabilizers
Kobelt Hydraulic Steering
(2) Air Compressors
(2) Freshwater pressure sets
(2) 1,200 gal/day watermaker
(3) Hot water heaters
Aqua Air AC/heat system
Atlas Transformer
Battery Chargers
Engine Room Blower System
Air Cond. Eng.Rm. & Mach. Space
All deck hardware 316L Stainless Steel
(2) Maxwell 6000 Anchor Windlasses
(2) Maxwell 4000 Warping Capstans
Stainless Anchor Pocket & (2)185KG SHHP Anchors W/300 ft. 5/8" Stud Link Chain P/S
Coast Guard approved Safety Equipment
Hydraulic Passerelle

Master Stateroom & Bath

- Full King size bed
- Built in nightstands & dresser
- Cedar lined closets w/lights
- Built in EntertainmentCenter w/43" LCD TV
- Fixed Windows
- Built in settee
- His and Hers Custom Vanities
- Marble tops w/Lav. Bowls
- Headhunter Toilets
- Oversized stall shower
- Exhaust fan system
- Custom Mirrors
- Lighting recessed in ceiling
- AC/heat system w/digital controls
- Floor & wall coverings



All Ocean Yachts Overing 100' Explorer

Guest Staterooms & Bath

- One Queen, & One Twin cabin
- Built in nightstands & dresser
- Cedar lined closets w/lights
- Drawer space built in under beds
- Built in Entertainment Center w/22" LCD TV
- Opening Portlights
- Custom Vanities w/mirrors
- Marble tops w/Lav. Bowls
- Headhunter Toilet
- Shower
- Exhaust fan system
- Lighting recessed in ceiling
- AC/heat system w/digital controls
- Floor & wall coverings

Captain's Cabin

- Double bed
- Built in nightstands & dresser
- Cedar lined closets w/lights
- Drawer space built in under beds
- Built in Entertainment Center w/22" LCD TV
- Built in Desk
- Fixed Portlight
- Custom Vanities w/mirrors
- Corian tops w/Lav. Bowl
- Headhunter Toilet
- Oversized stall shower
- Exhaust fan system
- Lighting recessed in ceiling
- AC/heat system w/digital controls
- Floor & wall coverings

Crew Quarters

- One stateroom for Two crew
- Cedar lined closets w/lights
- Headhunter Toilet

Crew Galley

- Soaking Sink
- Washer & Dryer

Crew Lounge

- Built in settee
- Built in Entertainment Center w/22" LCD TV



All Ocean Yachts Overing 100' Explorer

Aft Main Deck

- Custom Built in Seating w/ tables & loose chairs supplied by Owner
- Custom Built-in Bar w/Soaking Sink, Refrig. & Ice Machine

Main Salon

- Loose Furniture supplied by Owner
- Built in Entertainment Center w/43" LCD TV
- Lighting recessed in ceiling
- AC/heat system w/digital controls
- Floor & wall coverings

Formal Dining

- Dining Table & Chairs supplied by Owner.
- Fore & Aft China Cabinets
- Lighting recessed in ceiling
- AC/heat system w/digital controls
- Floor & wall coverings

Main Lobby & Powder Room

- Coat locker
- Powder Room Vanity w/mirror
- Granite tops w/Lav. Bowl
- Head Hunter Toilet
- Exhaust fan system
- Floor & wall coverings

Galley

- Custom mica cabinets & Corian tops
- Refrig/Freezer w/ ice & water dispenser
- (2) Self cleaning ovens
- Microwave oven
- Dishwasher
- Trash Compactor
- Food Lift
- Surface range w/exhaust hood
- Double Stainless sink w/disposal
- Undercounter & overhead lighting
- Two Pantries
- AC/heat system w/digital controls
- Floor & wall coverings



All Ocean Yachts Overing 100' Explorer

Pilothouse

- Custom padded control console w/elevated helm station
- Separate navigation center
- Full instrumentation
- Recaro Helm chair
- Custom elevated settee & table
- \Five windshield wipers/washers
- Built in chart drawers
- Recessed white & red lighting & ceiling
- AC/heat system w/digital controls
- Floor & wall coverings
- Custom Safety Panel & Monitoring System

Boat Deck

- Chocks for Owner-furnished 19' & 12' Tender
- (1) 3000 lb. Hydraulic Crane

Flybridge

- Custom Canopy & Mast
- Custom Bar w/6 stools, Refrig/Freezer & Stainless grill
- Custom seating w/cushions & Buffet

Teak Decks

- Swim Platform, Main Deck, 01 & 02 Decks shall be covered w/Burma Teak

Tenders

Chocks for owner-furnished 19' and 12' Tenders
1 3000 lb hydraulic crane

Disclaimer

The company offers the details of this vessel in good faith but cannot guarantee or warrant the accuracy of this information nor warrant the condition of the vessel. A buyer should instruct their agents, or their surveyors, to investigate such details as the buyer desires validated. This vessel is offered subject to prior sale, price change, withdrawal without notice, and tax when applicable.



All Ocean Yachts Overing 100' Explorer



All Ocean Yachts Overing 100' Explorer

+44 (0) 207 183 4393 • ENQUIRIES@TJBSUPERYACHTS.COM

24.11 CODA STUDIOS, 189 MUNSTER ROAD, FULHAM, LONDON, SW6 6AW, UK