



world yacht group

Experts in luxury yachts

NINITAS A



LOA:	100' 2" (30.51m)	Delivery/Model	2017
Beam:	22' 4" (6.8m)	Year:	
Max Draft:	7' 2" (2.16m)	Model:	100 CENTURY
Tonnage:	178.00	Builder:	ASTONDOA
Speed:	20 Knots 24 Knots	Type:	Motor Yacht
Flag:	British	Staterooms:	5
Location:	Alicante, Valencia Spain	Fuel Cap:	10900 L (2879.48 Gal)
VAT Paid:	VAT Unpaid	Water Cap:	2100 L (554.76 Gal)
		Engines:	2x, MTU, Model 16V 2000 M86,
		Price:	(\$6,694,043 USD est.) €5,950,000 EUR

Generated On 5/11/2025 6:19 AM by WORLD YACHT GROUP SVC Account

WORLD YACHT GROUP USA

WORLD YACHT GROUP SVC

NINITAS A

Account

**info160920210306@world-yacht-
group.com**

worldyachtgroup.com

Page 1 of 18

Additional Specifications For NINITAS A :

LOA:	100' 2" (30.51m)	Delivery/Model	2017
Beam:	22' 4" (6.8m)	Year:	
Max Draft:	7' 2" (2.16m)	Year Built:	2017
Hull Material:	GRP	Builder:	ASTONDOA
Superstructure:	GRP	Model:	100 CENTURY
Tonnage:	178.00	Type:	Motor Yacht
Range At Cruise		Engines:	Twin, MTU, Model 16V 2000 M86, 1051hrs / 1054hrs
Speed:		Staterooms:	5
Range At Max		Sleeps:	8
Speed:		Crew Quarters:	3
Speed:	Cruising 20 Knots	Captain Cabin:	Yes
	Max 24 Knots	Classifications:	RINA C+HULL;Y-UNRESTRICTED
Int Designer:	CHRISTIANO GATTO DESIGN	MCA:	ISM:
Ext Designer:	ASTONDOA S.A. (ASTILLEROS)		
Fuel Capacity:	10900 L (2879.48 Gal)		
Water Capacity:	2100 L (554.76 Gal)		
Flag:	British		
Location:	Alicante, Valencia Spain		
Price:	(\$6,694,043 USD est.) €5,950,000 EUR		
Tax Status:	VAT Unpaid		

CLASS & TAX STATUS
RINA C+HULL;Y-UNRESTRICTED

GENERAL CAPACITIES

Maximum Speed / Consumption: 24 knots / xxx
Economical speed / Consumption : 17 knots / 343 l/h
Range (approx): 500 nm @13 knots – ***Autonomy detailed below
Fuel capacity: 10,900 liters
Water capacity: 2,100 liters

*****AUTONOMY**

State of Weights:

Gas Oil: 92 %
Fresh Water: 100 %
10 persons

rpm	Speed Consumption Range		
	[Knots]	[l/h]	[nm]
1000	10,2	88	1200
1100	10,9	120	941
1200	11,7	156	777
1300	12,2	196	645
1400	12,8	258	514
1500	13,4	288	482
1600	14,0	344	421
1700	14,7	416	366
1800	15,1	496	315
1900	16,4	580	293
2000	18	680	274
2100	20	728	284
2200	21,5	794	280
2280/2300	22,6	838	279

NOTE1. 5 % of gas oil not consumed
NOTE2. Without generator

MACHINERY

Engine model: 2 x MTU – Model 16V 2000 M86ED
Engine hours: Port: 1,051 hrs (Nov 2022) Stb. 1,054 hrs (Nov 2022)
Propulsion: Diesel Prop Shaft
Steering: ZF 360
Stabilizers: Side-Power Stabilizer Systems model SPS 93 series

Generators

Generators: 2 x Kohler 40EFOJDZ
Generator hours: Gen 1 Port: 1,703 hrs (Nov 2022)
Gen 2 Stbd: 1,695 hrs (Nov 2022)

Air Conditioning

3 x chiller units Gianneschi and Schneider frequency inverter

ACCOMODATION

8 guests in 4 staterooms
4 + Captain , Crew in 3 cabins
Guests - Master stateroom, 3 double cabins (2 with double beds, 1 with two single beds)
Crew - 2 x twin (bunks). 1 x single bed

GALLEY & LAUNDRY EQUIPMENT

Laundry

- Washer Miele W1
- Dryer Miele T1 Eco
- Beam Electrolux vacuum equipment (corridor guest area)

Galley

- Miele induction glass-ceramic
- Falmec cooker hood
- 1 Miele oven
- 1 Miele microwave
- 1 Miele wine cellar
- Tm electron toaster
- 2 x DeLonghi Nespresso coffee machines
- Miele Triflex HX1 Pro vacuum cleaner
- The kitchen has individual air conditioning
- 3 x Refrigerators and freezer Miele Dynacool (in galley and crew aisle)
- 4 x Isotherm fridge and freezer
- Isotherm ice machine
- Kenyon electric iron

Generated On 5/11/2025 6:19 AM by WORLD YACHT GROUP SVC Account

WORLD YACHT GROUP USA

WORLD YACHT GROUP SVC

NINITAS A

Account

**info160920210306@world-yacht-
group.com**

worldyachtgroup.com

Page 3 of 18

COMMUNICATIONS & NAVIGATION EQUIPMENT

- 5 x Automatic electric bilge pumps SPX L2200-2060 GPH in bilge and manual bilge pump .
- 2 x Mastervolt Mass Charger 24/100 battery chargers
- 4 x Victron energy Orion Battery Chargers / DC/DC Converters.
- 2 x Lofrans electric windlasses
- Reflector radar
- Side-Power bow maneuvering propeller
- Side-Power stern maneuvering propeller
- Air conditioning system Dometic Condaria
- 2 x Astondoa rudder wheels
- 3 x Displays multifunction Simrad (CCTV, Radar, Plotter)
- 4 x MTU main motor displays.
- 2 x Displays Simrad
- Compass Artica.
- Compass LawranceSimrad Precision-9
- 2x Display indicator Simrad navigation parameters (wind, speed, depth)
- 2 x Simrad AP70 Autopilot.
- 3 x MTU engines.
- 1 x Cartography Plotter.
- 3 x Side-Power maneuvering propellers.
- 4 x MTU engine starter panels
- 2 x Humphree interceptor control.
- Control Wipers Speich
- 2 x MTU dynamic positioning knobs.
- Jabsco search focus control.
- Satellite phone and VHF Sailor 6222 VHF DSC.
- 2 x General lighting controls, anchoring equipment, alarms
- Inmarsat-C Sailor printer
- Transponder Radar SafeSea S100 SART
- AIS class A transponder em-trak A100
- Inmarsat-C Sailor 6006
- Display control stabilizers Side-Power
- Navtex Easy Navtex.
- Display state batteries Maretron DSM150
- VHF Sailor
- 4 x VHF Icom
- Display multifunciónSimrad NSS EVO3
- Compressed gas cylinder N.O.S.
- 5 x Greywater tanks 0.5 m3 each approximately
- Sewage tank of 500 liters.
- Fragrance system.
- 2 stabilizers Side-Power SPS93.
- Air compressor Newco Intertec N4-50C-3T
- 2 x fuel tanks total capacity 9,200 liters.
- Extra fuel tank of 1,700 liters
- Seafai Versatile water treatment plant
- 2 x Humphree interceptors
- Aspiradora Miele Triflex HX1 Pro
- 2 x Jacuzzis
- Sauna
- Opecmare hydraulic walkway

ENTERTAINMENT EQUIPMENT

- 6 x Ipad mini
- 8 x Samsung TVs
- 6 x Yamaha Aventure RX-A860 stereos
- Equipment of music Yamaha Aventure RX-A2080

DECK EQUIPMENT

- Anchoring equipment: composed of 2 anchors
- 2 Lofrans electric windlasses covered by anti-spray tarpaulin, controlled from the bow itself or from the government posts.
- Bow access: hose for stowage of ropes, equipment and cleaning material, life rings, fire hoses and respect equipment
- Wooden table and padded seats around in the bow, with folding bimini
- Padded solarium with coasters on both sides

SAFETY & SECURITY EQUIPMENT

- Marinelec fire detection panel
- 15 x ABC powder fire extinguishers
- Novec 1230 fire system
- 2 x Extintfuego Firefighter Suits
- Lalizas SCBA self-contained breathing apparatus
- 2 x Life rafts for 25 people each Hammar H20

TENDEERS & TOYS

- Jet ski BRP Spark
- Auxiliary boat William Turbojet 445 standard
- 2 x Seabobs.
- Weber/Textron 846 MAR TC-100
- Jobewater skis and life jackets

REFIT HISTORY

The boat has a lower deck, where you can find 3 double cabins for guests and 3 cabins for crew, one of them being modified after the construction of the boat, not being reflected in the original plans. In a testament to Astondoa's versatility, the space where the fourth cabin would normally sit has been used to fit a SPA complete with Jacuzzi and hammam.

Skipper cabin: this cabin was formerly a crew cabin, later modified by Astondoa S.A. Shipyards, now being the skipper's cabin.

CONCLUSION

NINITAS A an Astondoa Century series built to commemorate the hundred years anniversary of this Spanish shipbuilder has been refitted to include a spa cabin that can be converted back to a fifth guest cabin and an extra separate Captain's cabin on the lower deck. Her interior is modern and stylish, and her flybridge is extremely spacious running almost the entire length of the yacht while maintaining wide and practical side passages. Her retractable sunroof offers the perfect set up for sun-worshippers amidships. She has been inspected in November 2022 and is found to be in great condition. VAT excl.







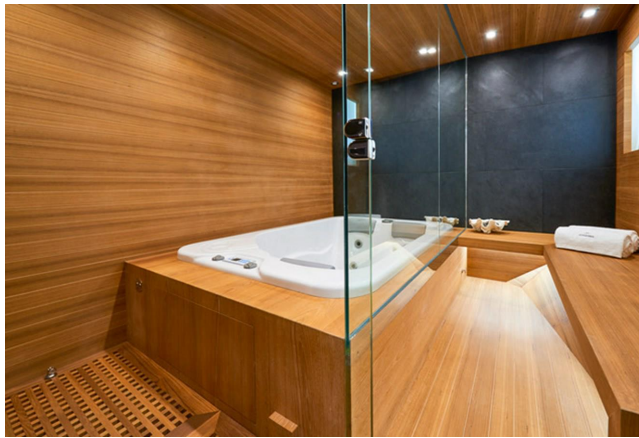



Generated On 5/11/2025 6:19 AM by WORLD YACHT GROUP SVC Account

WORLD YACHT GROUP USA

WORLD YACHT GROUP SVC

NINITAS A

Account

**info160920210306@world-yacht-
group.com**

worldyachtgroup.com

Page 10 of 18



Generated On 5/11/2025 6:19 AM by WORLD YACHT GROUP SVC Account

WORLD YACHT GROUP USA

WORLD YACHT GROUP SVC

NINITAS A

Account

**info160920210306@world-yacht-
group.com**

worldyachtgroup.com

Page 11 of 18



Generated On 5/11/2025 6:19 AM by WORLD YACHT GROUP SVC Account

WORLD YACHT GROUP USA

WORLD YACHT GROUP SVC

NINITAS A

Account

info160920210306@world-yacht-
group.com

worldyachtgroup.com

Page 12 of 18



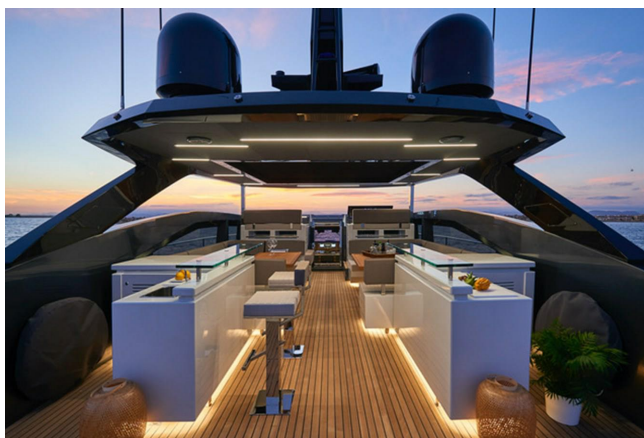

Generated On 5/11/2025 6:19 AM by WORLD YACHT GROUP SVC Account

WORLD YACHT GROUP USA

WORLD YACHT GROUP SVC

NINITAS A

Account

**info160920210306@world-yacht-
group.com**

worldyachtgroup.com

Page 14 of 18



Lower Deck

SPA cabin, included

Modification by

initially

Captain's cabin



Garag

Camera of
Machines

Guest Area

Zone
Crew

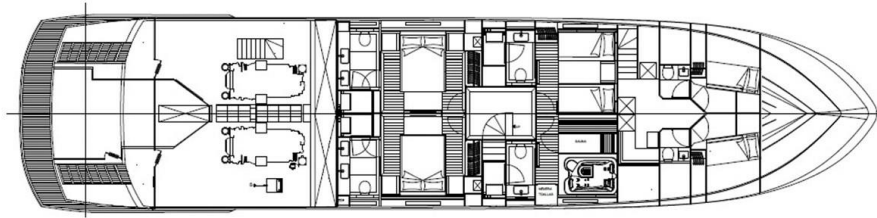

Crew Quarters

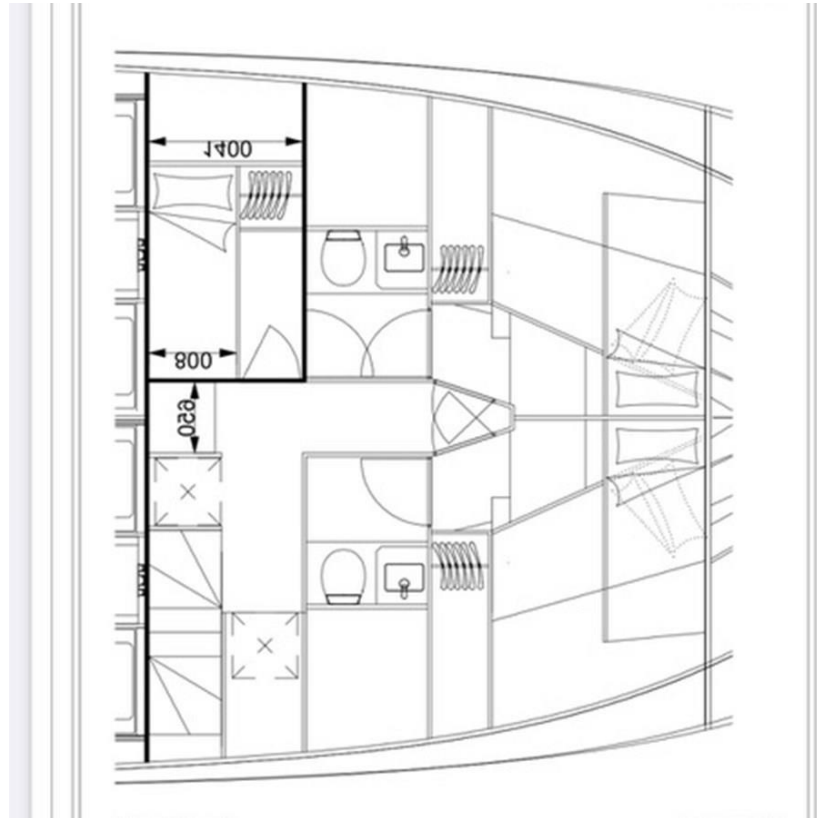

Captain's Cabin

