



world yacht group

Experts in luxury yachts

Knot Guilty



LOA:	76' 6" (23.32m)	Delivery/Model	2013
Beam:	19' 8" (5.99m)	Year:	
Max Draft:	5' 5" (1.65m)	Model:	76 Alpha
Tonnage:	0.00	Builder:	CHEOY LEE
Speed:	30 Knots 38 Knots	Type:	Motor Yacht Flybridge
Location:	Miami Beach, Florida United States	Staterooms:	3
VAT Paid:		Fuel Cap:	1060 Gal
		Water Cap:	264 Gal
		Engines:	2x, CAT, C32A, 1900 HP
		Price:	\$1,695,000 USD

Generated On 5/8/2025 11:56 PM by WORLD YACHT GROUP SVC Account

WORLD YACHT GROUP USA

WORLD YACHT GROUP SVC

Knot Guilty

Account

**info160920210306@world-yacht-
group.com**

worldyachtgroup.com

Page 1 of 16

Additional Specifications For Knot Guilty:

LOA:	76' 6" (23.32m)	Delivery/Model	2013
Beam:	19' 8" (5.99m)	Year:	
Max Draft:	5' 5" (1.65m)	Year Built:	2013
Hull Material:	Composite	Builder:	CHEOY LEE
Hull Config:	Deep Vee	Model:	76 Alpha
Range At Cruise		Type:	Motor Yacht Flybridge
Speed:		Engines:	1900 HP, Twin, Inboard, Diesel, CAT, C32A, 1250hrs / 1250hrs
Range At Max		Staterooms:	3
Speed:		Sleeps:	6
Speed:	Cruising 30 Knots	Heads:	4
	Max 38 Knots	Captain Cabin:	No
Int Designer:	Luis de Basto	Classifications:	
Fuel Capacity:	1060 Gal	MCA:	ISM:
Water Capacity:	264 Gal		
Location:	Miami Beach, Florida		
	United States		
Price:	\$1,695,000 USD		

Recent Upgrades:

- Yacht Controller
- New house batteries
- New Mastervolt Charger/Inverter
- New Oceanled underwater lights
- New Wi-Fi
- New AC chillers with 5 year warrant
- New washer and dryer
- New 19" Garmin GPS 8500 series with full engine display
- V-KOOL front windows
- New Simrad VHF
- New mesh window screens
- New Onyx tables
- New Sunbrella covers
- New cockpit, bow and flybridge tables
- New flybridge settees
- New carpeting and Logitech Elite remotes

The retail price in 2013 was: \$4,750,000, now you can own this beautiful yacht for only \$1,850,000

Aft Deck:

- Aft deck dining area sits immediately ahead of an island sun pad
- Sun shade provided by an awning that powers out from a sleek compartment in the hardtop
- 4-person hot tub beneath the sun pad Jacuzzi

Salon:

- Spacious salon for entertaining on main deck
- Precise joinery, meticulous design and attention to detail by Luis deBasto interior
- Comfortable elevated settee with upgraded stone table next to helm station allows for exquisite views while cruising
- Complete helm station with a double wide stidd helm chair

Galley:

- Centrally located on the main deck, the galley serves the dining area, aft deck, flybridge and fore deck seating areas
- Miele electric cooktop
- Miele stainless steel microwave/convection oven with hood
- Miele stainless steel refrigerator/freezer
- Miele stainless steel dishwasher
- Garbage compactor
- U-Line wine refrigerator

Master Stateroom with en-suite head:

- Full beam master offers bright space and sea views that create the perfect atmosphere to relax and unwind
- Large hull side windows that extend through into the ensuite bathroom and cedar lined walk in wardrobe
- Marble lined master head includes a large jacuzzi tub

Guest Staterooms with en-suite heads:

- (2) Spacious guest staterooms; one port and one forward
- Both w/ island double berths and en suite heads
- Abundant storage

Lower Deck:

- Foyer
- Day head
- Laundry room equipped with new Electrolux washer and dryer, and fitted with linen storage lockers

Crew:

- Two crew can be accommodated aft with separate access to their self contained quarters from aft deck

RPM Knots GPH:

Test Conditions: Speeds were measured by GPS off Fort Lauderdale, Florida, in three- to four-foot seas and 15 to 20 knots of wind, with a $\frac{3}{4}$ load of fuel, $\frac{1}{2}$ water and eight people on board. Fuel consumption was calculated by the engine-monitoring system.

700 8.0 10.8
900 10.9 23.0
1200 13.6 47.6
1500 20.0 80.8
1800 27.0 132.0
2100 32.1 161.4
2260 38.0 200.0

Electrical Systems:

- AC and DC electrical panels with breakers for all circuits
- 2 x 12v battery banks with cross over for generator start/audio-visual service
- Battery parallel system for main engine start batteries
- Automatic LED wardrobe lights
- LED navigation lights
- Remote controlled ACR 100 searchlight
- AC receptacles in galley, heads, engine room, laundry and exterior have GFI -protection
- 100A shore power inlet with 100' cable
- Glendinning Cablemaster, shore power cable retrieval system
- Copper bonding of through-hull fittings and equipment to exterior hull anodes
- Dynaplate with strap to ground terminal boards
- CO detectors in all living spaces

Navigation and Vessel System:

- Furuno TZT9 Navigation System
- Two Furuno 19" Screens In Pilothouse
- Garmin 19" Touch Screen on Flybridge
- Furuno 19 Screens On Flybridge
- Furuno DRS6A 64nm Radar
- Furuno DFF1 Digital Sounder
- Furuno GP330B GPS/WAAS
- Furuno Navpilot 711 Autopilot
- Simrad RS25 VHF
- Simrad RS35 VHF
- NEW 19" Garmin GPS 8500 Series with full engine display
- Magnetic Compass
- Satellite TV System
- LED navigation lights
- LED overhead and courtesy lighting
- Maretron control system with repeater on flybridge
- Chilled water air conditioning with soft starters
- Microprocessor controlled engine room ventilating system
- Auto/manual FM200 fire fighting system, alarms with automatic blower shutoff and inlet damper closure
- Power hydraulic steering system, including valves for autopilot installation
- Engine driven emergency bilge pump
- ZIPWAKE fully automated active interceptor system for comfort and stability
- Defroster for pilothouse windscreen glass
- Demisters on air intakes
- Remote controlled ACR 100 searchlight
- Large sports locker under aft deck sunbed
- Swim ladder
- Electric windlass, 200 ft High Test chain and 50kg Bruce type anchor
- 100A shore power inlet with 100' cable on Glendinning Cablemaster
- ZF 5200 low profile electronic engine controls
- ZF JMS joystick maneuvering system with extra ZF joystick on aft deck
- PPI dual helm seats at upper and lower stations
- Electric heads (fresh water flush)
- Ariston washer/dryer

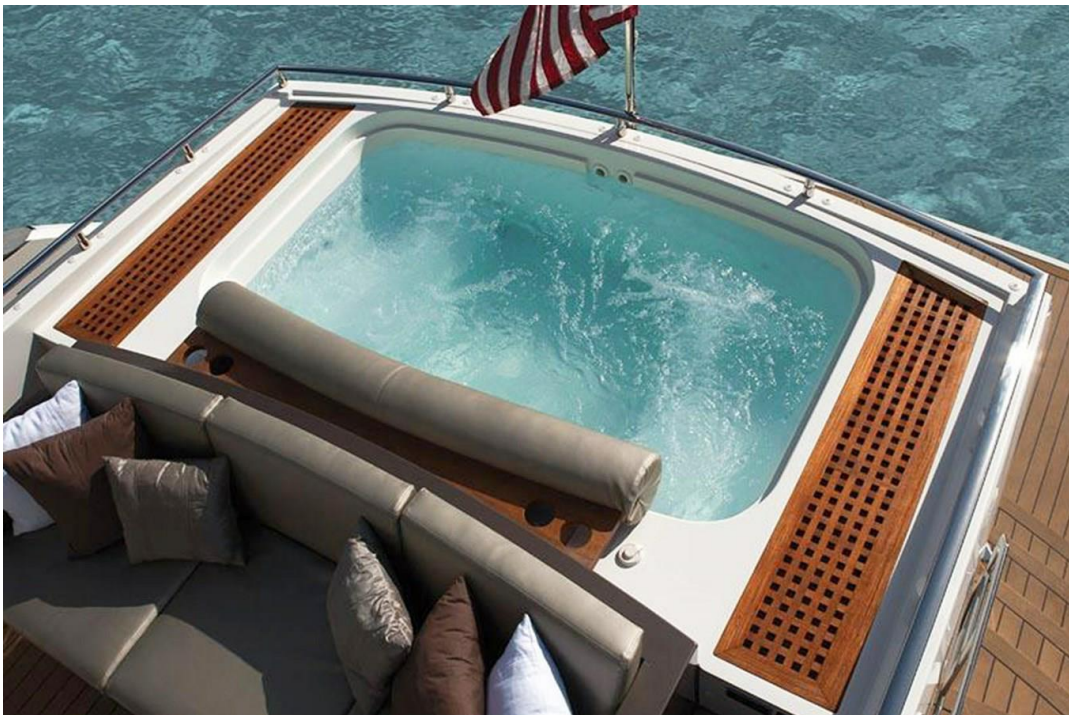

Generated On 5/8/2025 11:56 PM by WORLD YACHT GROUP SVC Account

WORLD YACHT GROUP USA

WORLD YACHT GROUP SVC

Knot Guilty

Account

**info160920210306@world-yacht-
group.com**

worldyachtgroup.com

Page 6 of 16



Generated On 5/8/2025 11:56 PM by WORLD YACHT GROUP SVC Account

WORLD YACHT GROUP USA

WORLD YACHT GROUP SVC

Knot Guilty

Account

**info160920210306@world-yacht-
group.com**

worldyachtgroup.com

Page 7 of 16



Generated On 5/8/2025 11:56 PM by WORLD YACHT GROUP SVC Account

WORLD YACHT GROUP USA

WORLD YACHT GROUP SVC

Knot Guilty

Account
info160920210306@world-yacht-
group.com
worldyachtgroup.com

Page 8 of 16





Generated On 5/8/2025 11:56 PM by WORLD YACHT GROUP SVC Account

WORLD YACHT GROUP USA

WORLD YACHT GROUP SVC

Knot Guilty

Account
info160920210306@world-yacht-
group.com
worldyachtgroup.com

Page 10 of 16



Generated On 5/8/2025 11:56 PM by WORLD YACHT GROUP SVC Account

WORLD YACHT GROUP USA

WORLD YACHT GROUP SVC

Knot Guilty

Account
info160920210306@world-yacht-
group.com
worldyachtgroup.com

Page 11 of 16



Generated On 5/8/2025 11:56 PM by WORLD YACHT GROUP SVC Account

WORLD YACHT GROUP USA

WORLD YACHT GROUP SVC

Knot Guilty

Account
info160920210306@world-yacht-
group.com
worldyachtgroup.com

Page 12 of 16



Generated On 5/8/2025 11:56 PM by WORLD YACHT GROUP SVC Account

WORLD YACHT GROUP USA

WORLD YACHT GROUP SVC

Knot Guilty

Account
info160920210306@world-yacht-
group.com
worldyachtgroup.com

Page 13 of 16

Upper Deck

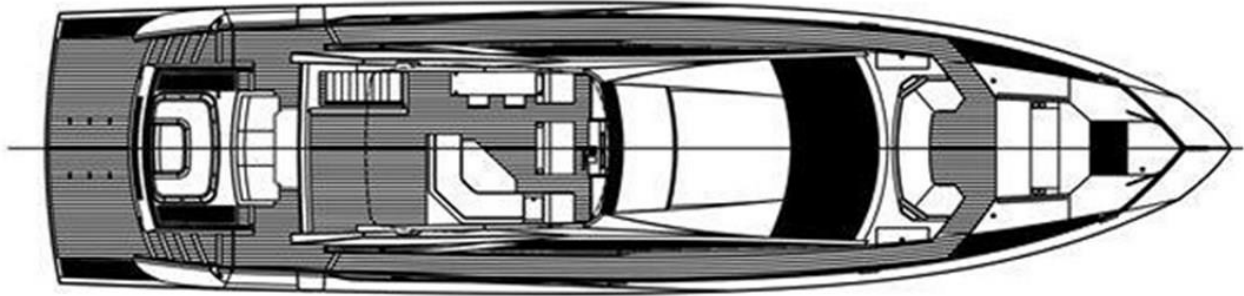

Generated On 5/8/2025 11:56 PM by WORLD YACHT GROUP SVC Account

WORLD YACHT GROUP USA

WORLD YACHT GROUP SVC

Knot Guilty

Account
info160920210306@world-yacht-
group.com
worldyachtgroup.com

Page 14 of 16

Main Deck

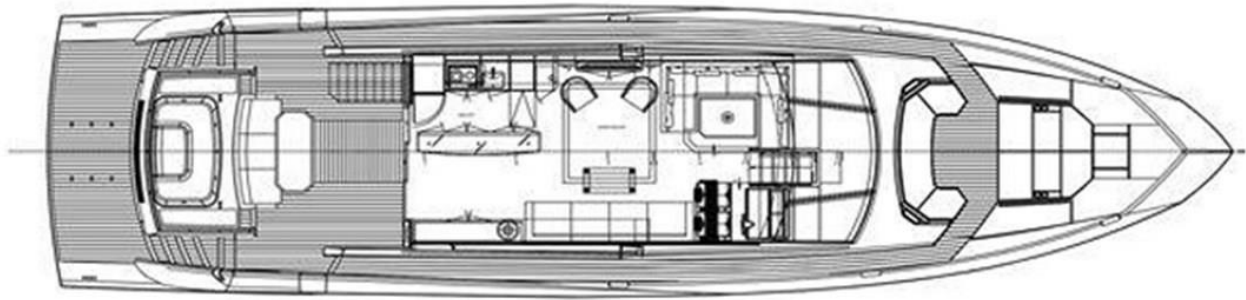

Generated On 5/8/2025 11:56 PM by WORLD YACHT GROUP SVC Account

WORLD YACHT GROUP USA

WORLD YACHT GROUP SVC

Knot Guilty

Account

**info160920210306@world-yacht-
group.com**

worldyachtgroup.com

Page 15 of 16

Lower Deck

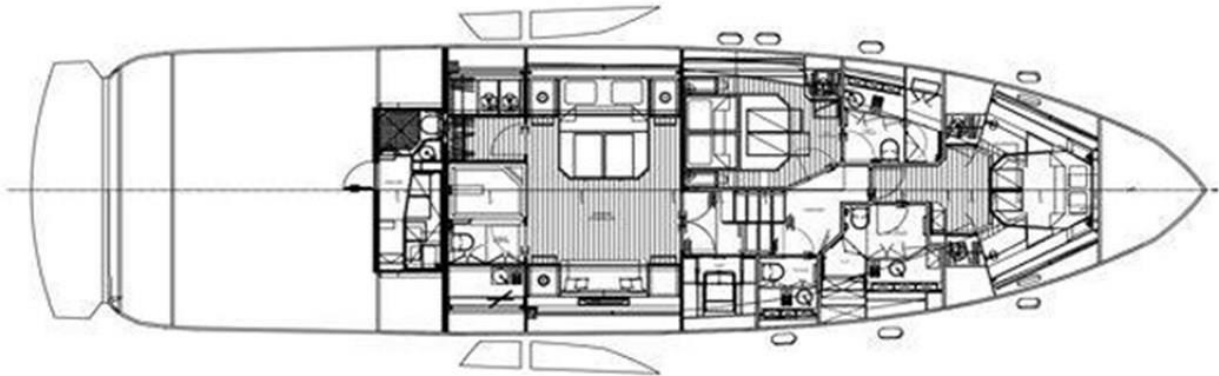

Generated On 5/8/2025 11:56 PM by WORLD YACHT GROUP SVC Account

WORLD YACHT GROUP USA

WORLD YACHT GROUP SVC

Knot Guilty

Account

**info160920210306@world-yacht-
group.com**

worldyachtgroup.com

Page 16 of 16