



world yacht group

Experts in luxury yachts

JOHNSON 92 FLYBRIDGE



LOA:	92' (28.04m)	Delivery/Model	2025
Beam:	24' (7.32m)	Year:	
Tonnage:	208.00	Model:	RPH w/On Deck Master
Speed:	22 Knots	Builder:	JOHNSON
Flag:	N/A	Type:	Motor Yacht Flybridge
Location:	Kaohsiung, Kaohsiung Taiwan	Staterooms:	5
VAT Paid:	US Duty Paid	Fuel Cap:	3434 Gal
		Water Cap:	475 Gal
		Engines:	2x, CAT, C-32 ACERT, 1925 HP
		Price:	\$10,995,000 USD

Generated On 4/16/2026 10:34 PM by WORLD YACHT GROUP SVC Account

WORLD YACHT GROUP USA

WORLD YACHT GROUP SVC

JOHNSON 92 FLYBRIDGE

Account

**info160920210306@world-yacht-
group.com**

worldyachtgroup.com

Page 1 of 25

Additional Specifications For JOHNSON 92 FLYBRIDGE:

LOA:	92' (28.04m)	Delivery/Model	2025
Beam:	24' (7.32m)	Year:	
Min Draft:	6' 1" (1.85m)	Year Built:	2025
Hull Material:	Fiberglass	Builder:	JOHNSON
Hull Config:	Deep Vee	Model:	RPH w/On Deck Master
Hull Designer:	DIXON YACHT DESIGN	Type:	Motor Yacht Flybridge
Deck Material:	Teak	Engines:	1925 HP,Twin, 2023, Inboard, Diesel, CAT, C-32 ACERT,
Tonnage:	208.00	Staterooms:	5
Range At Cruise		Sleeps:	10
Speed:		Heads:	8
Range At Max		Crew Quarters:	2
Speed:		Crew Berths:	3
Speed:	Max 22 Knots	Captain Cabin:	No
Int Designer:	JOHNSON YACHTS	Classifications:	
Ext Designer:	DIXON YACHT DESIGN	MCA: ISM:	
Fuel Capacity:	3434 Gal		
Water Capacity:	475 Gal		
Holding Tank:	150 Gal		
Flag:	N/A		
Location:	Kaohsiung, Kaohsiung Taiwan		
Price:	\$10,995,000 USD		
Tax Status:	US Duty Paid		

I. HULL & DECK

1. MAIN DECK-TEAK 14MM

2. HIGH BULWARK W/FLUSH MOUNTED LED DECK LIGHTS, TWO REAR BULWARK SIDE DOORS FOR BOARDING (ONE BOARDING GATE ON EACH SIDE)

3. STAINLESS STEEL INTEGRAL ROLLERS & CHAIN STOPPER FOR DUAL ANCHOR CHAIN

4. VERTICAL ELECTRIC ANCHOR WINCHES x 2:

MAXWELL VWC6000C/HYD.

VERTICAL HYDRAULIC WINDLASS, DUAL DIRECTION, CHROMED, MATCHED PAIR, WITH CHAIN WHEEL C1=3182/016 (1/2"HT) AND PARTS:

2 x AA560 ROPE/CHAIN COUNTER/REMOTE CONTROL

1 x BAND BRAKE

1 x CHAIN ROLLER STOPPER TENSIONER

1 x HAND HELD REMOTE CONTROL

5. AFT DECK MOORING CAPSTAN x 2 SETS:

MAXWELL VC2200W/D

VERTICAL ELECTRIC CAPSTAN, WIDE DRUM SINGLE DIRECTION, 24VDC, CHROMED, AND PARTS:

1 x FOOT SWITCH W/COVER

1 x 80 AMP BREAKER PANEL

1 x REVERSING SOLENOID PACKS, 24VDC

6. STAINLESS STEEL 250 LB ANCHOR x 2

7. HIGH TENSILE GALVANIZED ANCHOR CHAIN x 2:

LEFT: 300 FEET (5/8")

RIGHT: 300 FEET (5/8")

8. FRESH WATER ANCHOR CHAIN WASH DOWN

9. HEAVY DUTY S/S 3" OVAL HANDRAIL WITH 1 1/2" STANCHIONS

10. S/S FLAGPOLE ON BOW RAIL

11. BOW STORAGE LOCKER FOR FENDERS AND ANCHOR CHAINS

12. HEAVY DUTY 316# STAINLESS STEEL TWIN CLEATS AND FAIRLEADS WITH ROLLERS

13. BLACK TEMPERED SAFETY GLASS

14. STAINLESS STEEL PNEUMATIC SALOON SLIDING DOOR WITH BUTTON AND SAFETY SENSOR DEVICE

15. TWO PANTOGRAPH SIDE DOORS (PORT SIDE & STARBOARD SIDE) IN DECK HOUSE

16. STAINLESS STEEL PORTHOLES ALL WITH BLACKOUT SHIELDS/ ROUND PORT LIGHTS ON DECK HOUSE

Generated On 4/16/2026 10:34 PM by WORLD YACHT GROUP SVC Account

WORLD YACHT GROUP USA

WORLD YACHT GROUP SVC

JOHNSON 92 FLYBRIDGE

Account

**info160920210306@world-yacht-
group.com**

worldyachtgroup.com

Page 3 of 25

17. BUILT-IN HOT & COLD WATER SHOWER – SWIM PLATFORM:

SSI 48300000 STOWAWAY SHOWER UNIT WHITE x 1

18. LARGE TEAK INLAY SWIM PLATFORM WITH STAIRWAYS TO AFT DECK

19. FRP “U” SHAPE SEATING ON AFT DECK WITH CUSHION AND COVERS

20. AFT DECK CUSTOM SLIDING HIGH-LOW TABLE WITH COMPASS INLAY x 2

21. TENDER GARAGE

22. ANTI-FOULING BOTTOM PAINT:

SEA HAWK PRIMER SYSTEMS TUFF STUFF 1284 GREY OR 1285 WHITE

SEA HAWK SELF-POLISHING CO POLYMER ANTI-FOULING CUKOTE 3445 BLACK OR 3430 DARK BLUE

23. SINGLE BOOT STRIPE COLOR: BLACK

24. S/S HANDRAILS ON AFT DECK STAIRS WITH TWO INTERMEDIATE RAILS

25. LED FLOOD LIGHT ON THE END OF AFT DECK CEILING x 2

26. EXTERIOR STEP LIGHTS:

IMTRA KODIAK BLUE LED S/S 24V

27. RUB RAIL WITH S/S CAP ON LOWER AFT HULL SIDES

28. SOLID STAINLESS STEEL RUB RAIL AROUND HULL/DECK JOINT

29. ZINC ANODES ON TRANSOM, SHAFT AND BOW AND STERN THRUSTER

30. FRESH WATER WASH DOWN SPIGOTS ON THE BOW AND AFT DECK:

SCANDVIK 10187 S/S

31. AFT DECK REFRIGERATOR:

ISOTHERM CRUISE 90 FREEZER INOX 110V/60HZ

32. DECK WASHDOWN, SALT WATER:

FLOJET 4325-343L WATER PUMP 24V W/NOZZLE x 1

33. HYDRAULIC SWIMMING PLATFORM (BESENZONI PL850 OR EQUIVALENT W/ 1873 LBS LIFTING CAPACITY)

34. WATER FILL DECK FITTING x 2

35. DIESEL FILL DECK FITTING x 2

II. FLYBRIDGE

1. TEAK FLOOR

Generated On 4/16/2026 10:34 PM by WORLD YACHT GROUP SVC Account

WORLD YACHT GROUP USA

WORLD YACHT GROUP SVC

JOHNSON 92 FLYBRIDGE

Account

**info160920210306@world-yacht-
group.com**

worldyachtgroup.com

Page 4 of 25

2. FRP RADAR ARCH AND MAST

3. AIR HORN:

BUELL S/S AIR HORN COMPRISING:

1 X 5444-3 24V TANK MOUNTED COMPRESSOR
1 X 1062 12" STROMBOS AIR HORN
1 X 1063 15" STROMBOS AIR HORN
1 X 1064 18" STROMBOS AIR HORN

4. INTERNATIONAL NAVIGATION LIGHTS & CONTROLLER ALL LED AQUA-SIGNAL ONE SET (5):

3532-003 #55 MASTHEAD LIGHT 24V
3535-103 #55 STARBOARD LIGHT 24V
3534-203 #55 PORT LIGHT 24V
3533-703 #55 STERN LIGHT 24V
3531-703 #55 ALL-AROUND LIGHT 24V

5. CUSTOM WALK BEHIND WET BAR:

REGRIGERATOR/ICEMAKER: U-LINE CO29BTP-20 110V/60 HZ
FAUCET: GROHE
SINK
3 X BAR STOOLS
GRANITE TOP

6. FRP SETTEE WITH REMOVABLE CUSHIONS, STORAGE BELOW AND COVER

7. HELM STATION:

HELM SEAT - BESENZONI P217 HELM SEAT x 1
SEARCH LIGHT -ACR RCL-100 24V
ABT AT REST STABILIZER CONTROL AND MONITORING DISPLAY
ABT BOW & STERN THRUSTER CONTROL PANEL
DANFORTH 5" MAGNETIC COMPASS
FUEL GAUGE HEADHUNTER TS-3000 SERIES
RUDDER INDICATOR

CCTV SYSTEM:

FLIR DNR118 NETWORK VIDEO RECORDER LIR DNR118
FLIR N338FH IP DOME CAMERA x 3 (2 ON AFT DECK, AND 1 ON FOREDECK FACING WINCH)
FLIR AX8 MARINE THERMAL MONITORING CAMERA x 2 FOR ENGINE ROOM

GARMIN NAVIGATION SYSTEM:

I. FLYBRIDGE HELM & LOWER PILOTHOUSE:

GPSMAP® 8624 FULLY-INTERGRATED MULTI-TOUCH MFD x 3
GRID™ - GARMIN REMOTE INPUT DEVICE x 1
GARMIN CARD READER x 1
VHF 200 MARINE RADIO x 2
AIS™ 600 CLASS B BLACK BOX TRANSCEIVER x 1
GMS 10 NETWORK PORT EXPANDER x 2

Generated On 4/16/2026 10:34 PM by WORLD YACHT GROUP SVC Account

WORLD YACHT GROUP USA

WORLD YACHT GROUP SVC

JOHNSON 92 FLYBRIDGE

Account

**info160920210306@world-yacht-
group.com**

worldyachtgroup.com

II. CREW'S MESS:

GPSMAP® 7608 FULLY-INTERGRATED MULTI-TOUCH MFD x 1

GHS 10™ 10 WIRED VHF HANDSET x 1

III. AUTOPILOTING:

GHP REACTOR, HYDRAULIC W/SMARTPUMP COREPACK x 1

GRF 10 RUDDER FEEDBACK SENSOR x 1

IV. MAST/HARDTOP/RADAR ARCH:

GMR™ 2526 X HD2 OPEN ARRAY RADAR AND PEDESTAL (25KW/6FT/96NM) x 1

GMR FANTOM™ 6 OPEN ARRAY RADAR AND PEDESTAL (40W/6FT/72 NM) x 1

GPS 19X NMEA 2000 x 2

GXM™ 52 SIRIUS XM® MARINE RECEIVER x 1

V. SOUNDER & TRANSDUCER:

GSD™ 25 PREMIUM SONAR MODULE x 1

AIRMAR 1KW B265LH BRONZE THRU-HULL TRANSDUCER x 1

GARMIN GT51M-THP –S/S THRU-HULL PAIR DOWNVU/SIDEVU x 1

AIRMAR DST800 SMART SENSOR DEPTH, SPEE, TEMP, NMEA 2000 x 1

8. JACUZZI AT BRIDGE DECK AFT

9. S/S FLAG STAFF ON REAR OF FLYBRIDGE

10. S/S HATCH ON BRIDGE DECK STEP OPENING

11. LOW LEVEL COURTESY LED LIGHTS 24V

12. OVERHEAD LED LIGHTS

13. INTERLOCKING HEADLINER

III. ENGINE PROPULSION & STEERING SYSTEM

1. ENGINE:

CAT C-32 ACERT 1925 HP X 2 GEARBOX

ZF2070A MARINE GEAR RATIO 2.467: 1 x 2

2. SOUNDOWN ENGINES MOUNTS TO REDUCE VIBRATION

3. CAT ELECTRONIC ENGINE CONTROL SYSTEM, INCLUDING REMOTE STATION CONTROL & BACK-UP SYSTEM:

FIXED STATIONS x 1 AT PILOTHOUSE; REMOTE CONTROL STATION x 1 IN THE AFT DECK PORT SIDE

4. ENGINE FUEL FILTERS:

RACOR 75/1000MAX2 W/ALARM x 2

5. GENERATOR FUEL FILTERS:

RACOR 75/500MAX2 W/ALARM x 2

6. S/S SHAFTS:

AQUATECH 22 HIGH STRENGTH DIAMETER 4" x 2

Generated On 4/16/2026 10:34 PM by WORLD YACHT GROUP SVC Account

WORLD YACHT GROUP USA

WORLD YACHT GROUP SVC

JOHNSON 92 FLYBRIDGE

Account

**info160920210306@world-yacht-
group.com**

worldyachtgroup.com

7. HIGH PERFORMANCE 5-BLADE PROPELLERS:

HUNG SHEN NIBRAL PROPS x 2

8. MAIN & INTERMEDIATE BRONZE SHAFT STRUTS WITH BACKING PLATES

9. SHAFT & RUDDER PACKING GLANDS WITH MAINTENANCE FREE TIDE STRONG SEALS:

TIDES MARINE RUDDER SEAL DIAMETER 3-1/2" & SHAFT SEAL DIAMETER 4"

10. HYNAUTIC POWER STEERING SYSTEM WITH PTO ON BOTH ENGINES:

PSC-2252-21-2 DUAL STATION W/COOLING WATER FLOW DETECTOR

11. SEA WATER STRAINERS FOR ENGINE, GENERATORS, AIR CON AND WATER MAKER

12. SEA COCKS ON ALL UNDERWATER FITTINGS

13. S/S EMERGENCY TILLER

14. S/S RUDDERS:

DIAMETER 3-1/2"

15. HEAVY DUTY S/S WIPERS WITH VARIABLE SPEED CONTROLS & SCREEN WASHER SYSTEM EXALTO 24V X 4

16. BOW AND STERN THRUSTERS WITH CENTRAL HYDRAULIC SYSTEM

17. "AT REST" STABILIZER SYSTEM

18. STEERING WHEELS AT P/H & F/B:

S/S 22" DIAMETER x 2

19. DEANGELO EXHAUST SYSTEM W/ BYPASS

IV. ENGINE ROOM & EQUIPMENT

1. WELL PLANNED, SPACIOUS E/R WITH REMOVABLE NIDA-CORE DECK PLATES

2. PYROTEK NOISE CONTROL DESIGN SOUND INSULATED MATERIALS

3. WATER TIGHT BULKHEAD UP TO ENTRANCE DOOR

4. FULL LENGTH S/S GRAB RAIL ON EACH SIDE OF ENGINE

5. E/R AC LED LIGHTS & DC LED DOME LIGHTS

6. ENGINE COMPARTMENT BLOWER & MOISTURE ELIMINATOR:

DELTA "T" BLOWERS WITH 600-P/T4 CONTROL SYSTEM, ADJUSTABLE SPEED DRIVE AND COLOR TOUCH SCREEN:

-500-219183-45/8 INTAKE FAN W/DAMPER, AXIAL. 21 IN. x 2 SETS

Generated On 4/16/2026 10:34 PM by WORLD YACHT GROUP SVC Account

-500-215363-30/8 EXHAUST FAN W/DAMPER, AXIAL. 15 IN. x 2 SETS

7. AUTOMATIC FIRE EXTINGUISHING SYSTEM W/AUTOMATIC ENGINES & VENTILATION SHUTDOWN:

SEA-FIRE FM-200 24V

SEA-FIRE FIRE DETECTION & MONITORING SYSTEM THROUGHOUT THE BOAT

8. ENGINE ALARM SYSTEM FOR LOW OIL PRESSURE & HIGH WATER TEMPERATURE

9. HIGH VOLUME AC FRESH WATER PRESSURE PUMP & ONE DC PUMP FOR BACK UP:

HEADHUNTER XR-124 12-24VDC x 1

HEADHUNTER M5-230 MACH 5 230VAC x 2

10. CHILLED WATER AIR CONDITIONING UNITS LOCATED IN ENGINE ROOM:

CRUISAIR CHILLED WATER AIR CONDITIONING 230V/60HZ W/SMXHT DIGITAL CONTROL

AIR COMPRESSOR:

TWCX60 (60000 BTU) x 4

AIR HANDLER:

SALOON: 24000 BTU/HR x 1, 18000 BTU/HR x 1

GALLEY: 18000 BTU/HR x 1

KITCHEN: 24000 BTU/HR x 1

PILOTHOUSE: 18000 BTU/HR x 1

CARDROOM: 24000 BTU/HR x 1

MASTER STATEROOM: 24000 BTU/HR x 1, 18000 BTU/HR x 1

MASTER BATHROOM: 18000 BTU/HR x 1

PORT FWD GUEST CABIN/BATHROOM: 18000 BTU/HR x 1

PORT AFT GUEST CABIN/BATHROOM: 18000 /HR x 1

STBD FWD GUEST CABIN/BATHROOM: 18000 /HR x 1

STBD AFT GUEST CABIN/BATHROOM: 18000 /HR x 1

CAPTAIN CABIN: 9000 BTU/HR x 1

PORT CREW CABIN: 9000 BTU/HR x 1

STBD CREW CABIN: 9000 BTU/HR x 1

CREW MESS: 12000 BTU/HR x 1

11. FRP FUEL TANKS W/ HEADHUNTER FUEL GAUGE:

3434 GAL FUEL TANK x 1

12. OIL CHANGE PUMP SYSTEM FOR ENGINES, GENERATORS AND CLUTCHES:

REVERSO OP-704 24V x 1

13. HEAVY DUTY ENGINE ROOM DOOR WITH VIEWING WINDOW

14. MANUAL BILGE PUMP:

HENDERSON MK5 UNIVERSAL MOUNT PUMP x 1

15. FUEL TRANSFER PUMP W/ MECHANICAL FLOW METER:

Generated On 4/16/2026 10:34 PM by WORLD YACHT GROUP SVC Account

WORLD YACHT GROUP USA

WORLD YACHT GROUP SVC

JOHNSON 92 FLYBRIDGE

Account

**info160920210306@world-yacht-
group.com**

worldyachtgroup.com

TUTHILL FR2410C 24V 1/4HP x 2
TUTHILL 901-1 x 2

16. S/S COVER OUTSIDE ENGINE EXHAUST

17. FRESH-WATER HOSE FOR FILLING ENGINE AND GENERATOR AND EXPANSION TANK IN ENGINE ROOM:

BASIN: LP-7000 x 1
TAP: SCANDVIK 10477 COMPACT MIXER WHITE x 1
SHOWER DRAIN: RULE 98 800GHP 24V x 1

18. WATER MAKER:

SEA RECOVERY 1400GPD (ONE) COMPLETE PRE-FILTER, OIL/WATER SEPARATOR, CARBON FILTER, SRC FWF/AW AUTOMATICALLY RINSES WITH FRESH WATER

19. WORK BENCH OVER THE ENGINE X 2

V. ELECTRICAL SYSTEM

1. OCTOPLEX DISTRIBUTED POWER CONTROL AND MONITORING SYSTEM OF ALL MAIN SHIP SYSTEM INCLUDING BUT NOT LIMITED TO, TANK LEVEL ALARMS AND MONITORING, PUMP CONTROL, BILGE STATUS AND ALL ELECTRICAL LOAD MANAGEMENT

2. 110/220 VOLT ELECTRICAL SUPPLY FROM GENERATOR OR SHORE POWER

3. SHORE POWER INLET W/ RADIO REMOTE CONTROL IN THE TRANSOM:

GLENDINNING CABLE MASTER CM-8 100AMP 24V WITH 120' CABLE x 2 SETS
GLENDINNING RADIO REMOTE CONTROL 04155 (2 TRANSMITTERS) x 1 SET

4. INVERTERS:

VICTRON QUATTRO 48/500/70-100/100

5. COLOR-CODED WIRING FOR EASY IDENTIFICATION

6. GENERATOR:

ONAN MARINE DIESEL GENERATORS 55 KW 3 PHASE,(60HZ); 110V/220V 60HZ x 2 INCLUDING STANDARD EQUIPMENT(CONTROL PANEL): SOUND SHIELD, WET EXHAUST MUFFLER, GAS/WATER SEPARATOR

7. AUTOMATIC BATTERY CHARGER:

DOLPHIN 80 AMP 24V 115-230V 50/60HZ x 2 FOR SERVICE BATTERIES
PROTECH 12V 30AMP x 1 FOR GENERATOR BATTERIES

8. BATTERY SWITCH (VAPOR PROOF):

BEP 701-MDO x 3

9. 225 AMP/HR GEL CELL SEALED BATTERIES FOR SERVICE/ENGINES/GENSETS:

Generated On 4/16/2026 10:34 PM by WORLD YACHT GROUP SVC Account

WORLD YACHT GROUP USA

WORLD YACHT GROUP SVC

JOHNSON 92 FLYBRIDGE

Account

**info160920210306@world-yacht-
group.com**

worldyachtgroup.com

Page 9 of 25

SERVICE LIFELINE GPL-8DL 255AMP x 4
ENGINE LIFELINE GPL-8DL 255AMP x 4
GENSETS LIFELINE GPL-8DL 255AMP x 2

10. ALL BATTERIES ENCLOSED WITH FIBERGLASS BOXES AND COVERS

11. AC VOLT DUPLEX RECEPTACLES LOCATED THROUGHOUT INCLUDING ENGINE ROOM

12. GFI PROTECTION FOR AC REQUIRED OUTLETS:

VIMAR 16511.16B 120V~60HZ

13. AUTOMATIC ISOLATION & BOOSTING TRANSFORMER:

CHARLES 93-ISOBOST 100 AMP x 2

14. INDIRECT LED LIGHTING UNDER VALANCE IN SALOON, STATEROOMS, PILOTHOUSE, HAND RAILS,
AND GALLEY

15. COMPLETE ANTI ELECTROLYSIS BONDING SYSTEM VIA 2" COPPER STRAP AND HULL ANODES

16. SHORE TELEPHONE INLET:

HUBBELL PH6594TV x 1

VI. PLUMBING SYSTEM

1. FWD 150 GALLON HOLDING TANK WITH MACERATOR PUMP & AFT 50 GALLON TANK WITH MACERATOR.

2. WASTE TREATMENT SYSTEM IN E/R:

HEADHUNTER TW-HMX-512 1200GPD

3. SUMP PUMPS FOR SHOWERS:

RULE 12 24V/2000GPH x 3

4. BILGE PUMPS:

RULE 16A 24V/3700GPH x 7

5. FLOAT SWITCH:

LOW-SUREBAIL 382251 x 6

HIGH-SUREBAIL 382251 x 9

6. MARINE GRADE LINES FOR FRESH WATER SYSTEM

7. WATER HEATERS W/HOT WATER CIRCULATING PUMP:

WATER HEATER: TORRID MV40S 120V 1500W S/S 40 GALLONS x 2

HOT WATER CIRCULATING PUMP: GRUNDFOS UP10-16B5/ATLC 115V/60HZ x 1

8. 475 GAL S/S WATER TANKS W/ HEADHUNTER TS-3001B ELECTRIC WATER GAUGE

9. PRESSURE STORAGE TANKS:

HEADHUNTER AVF-4 4 GAL x 2

GROCO PST-1 1 GAL x 1

10. MANIFOLD FOR OVERBOARD DISCHARGES TO MINIMIZE NUMBER OF THRU-HULL FITTINGS, IN BRONZE WITH BALL VALVES

11. HIGH WATER BILGE ALARM SYSTEM - 7 AREAS

12. DOCKSIDE FRESH WATER INLET:

PAR JABSCO 44410-1001 x 1

13. COLOR CODED PIPING SYSTEM FOR EASY IDENTIFICATION

14. BRONZE INTAKE VALVES (BALL). ALL THRU-HULL FITTINGS ARE BRONZE

15. 2HP AC FIRE PUMP WITH ON-DECK FIRE HOSE

16. BILGE EXHAUST VENTILATION:

PAR 35740-0013 24V 3" FLANGE MOUNT BLOWER

VII. INTERIOR EQUIPMENT

Generated On 4/16/2026 10:34 PM by WORLD YACHT GROUP SVC Account

WORLD YACHT GROUP USA

WORLD YACHT GROUP SVC

JOHNSON 92 FLYBRIDGE

Account

**info160920210306@world-yacht-
group.com**

worldyachtgroup.com

1. HIGH QUALITY FABRIC SOFAS
2. INTERLOCKING VINYL CEILING PANELS THROUGHOUT
3. HIGH QUALITY DOOR LOCK SETS THROUGHOUT
4. LED LIGHTING SYSTEM THROUGHOUT:
CHROME TRIM & WHITE COLOR
5. ITALIAN SWITCH & OUTLETS THROUGHOUT:
VIMAR / CHROME TRIM
6. CHOICE OF FABRICS FOR BEDDING & CURTAINS
7. INDIRECT LED WARM WHITE LIGHTING SYSTEM THROUGHOUT, UNDER SOFAS, BEDS & CURTAIN VALANCES
8. INTERIOR STAIRWAYS WITH SAFETY LED LIGHT SYSTEM
9. CEDAR LINED HANGING LOCKER CABINET W/LED LIGHT IN EACH CABIN
10. PYROTEK NOISE CONTROL DESIGN OF SOUND INSULATION IN WALLS BETWEEN CABINS
11. CENTRAL VACUUM SYSTEM W/ OUTLETS:
NUTONE 110V/60 HZ x 1
12. CHROME COLOR BATHROOM FIXTURE THROUGHOUT
13. FROSTED GLASS FOR SHOWER DOORS
14. SALOON:
HIGH QUALITY CUSTOM BUILT UPHOLSTERED SOFA x 4
INTERLOCKING VINYL CEILING PANELS THROUGHOUT
S/S HIGH POLISH ELECTRICAL OPERATED DOOR
CUSTOM DESIGN DINING TABLE (FOR 8 PEOPLE)
CUSTOM DESIGN CEILING SOFFIT
CUSTOM DESIGN TV CABINET
NUVO WHOLE ZONE AUDIO SYSTEM
SHAPE LC-58U30 58" TV
PIONEER BLU-RAY DISC PLAYER
APPLE TV
18. MASTER CABIN:
INTERLOCKING VINYL CEILING PANELS
KING SIZE BED
CUSTOM DESIGN HEADBOARD
CUSTOM STORAGE CABINETS
POWER CURTAINS
VANITY LIGHT
CEDAR LINED WALKING CLOSET
READING LIGHTS:

Generated On 4/16/2026 10:34 PM by WORLD YACHT GROUP SVC Account

WORLD YACHT GROUP USA

WORLD YACHT GROUP SVC

JOHNSON 92 FLYBRIDGE

Account

**info160920210306@world-yacht-
group.com**

worldyachtgroup.com

SHAPE LC-50U30 50" TV
PIONEER BLU-RAY DISC PLAYER
NUVO WHOLE ZONE AUDIO SYSTEM
APPLE TV

19. PORT FWD GUEST CABIN:

INTERLOCKING VINYL CEILING PANELS
QUEEN SIZE BED
CUSTOM DESIGN HEADBOARD AND CEILING
CUSTOM STORAGE CABINETS
VANITY LIGHT: QUICK QB-COMPASS/CHROMED x 1
CEDAR LINED CLOSET
READING LIGHTS: QUICK ISABELLA 15-25 /CHROMED/SHADE LINEN/ B15D LED x 2
SHAPE LC-32LE275 32" TV
NUVO WHOLE ZONE AUDIO SYSTEM
APPLE TV

20. PORT AFT GUEST CABIN:

INTERLOCKING VINYL CEILING PANELS
QUEEN SIZE BED
CUSTOM DESIGN HEADBOARD AND CEILING
CUSTOM STORAGE CABINETS
VANITY LIGHT: QUICK QB-COMPASS/CHROMED x 1
CEDAR LINED CLOSET
READING LIGHTS: QUICK ISABELLA 15-25 /CHROMED/SHADE LINEN/ B15D LED x 2
SHAPE LC-32LE275 32" TV
NUVO WHOLE ZONE AUDIO SYSTEM
APPLE TV

21. STBD FWD GUEST CABIN:

INTERLOCKING VINYL CEILING PANELS
QUEEN SIZE BED
CUSTOM DESIGN HEADBOARD AND CEILING
CUSTOM STORAGE CABINETS
VANITY LIGHT: QUICK QB-COMPASS/CHROMED x 1
CEDAR LINED CLOSET
READING LIGHTS: QUICK ISABELLA 15-25 /CHROMED/SHADE LINEN/ B15D LED x 2
SHAPE LC-32LE275 32" TV
NUVO WHOLE ZONE AUDIO SYSTEM
APPLE TV

22. STBD AFT GUEST CABIN:

INTERLOCKING VINYL CEILING PANELS
QUEEN SIZE BED
CUSTOM DESIGN HEADBOARD AND CEILING
CUSTOM STORAGE CABINETS
VANITY LIGHT: QUICK QB-COMPASS/CHROMED x 1
CEDAR LINED CLOSET
READING LIGHTS: QUICK ISABELLA 15-25 /CHROMED/SHADE LINEN/ B15D LED x 2
SHAPE LC-32LE275 32" TV
NUVO WHOLE ZONE AUDIO SYSTEM
APPLE TV

23. CAPTAIN'S CABIN:

TEAK & HOLLY FLOORS
HANGING LOCKER
DOUBLE BED
DESK & READING LIGHTS
SHAPE LC-32LE275 32" TV
NUVO WHOLE ZONE AUDIO SYSTEM
APPLE TV

24. STBD CREW & PORT CREW QUARTERS:

TWIN BEDS
READING LIGHTS
NUVO WHOLE ZONE AUDIO SYSTEM

25. CREW MESS AREA:

SOFA SEATING AREA
DINNING TABLE
SHAPE LC-32LE275 32" TV
NUVO WHOLE ZONE AUDIO SYSTEM
APPLE TV
GARMIN GPSMAP® 7608 FULLY-INTERGRATED MULTI-TOUCH MFD x 1
GHS 10™ 10 WIRED VHF HANDSET x 1

VIII. GALLEY

1. TRASH COMPACTOR:

BROAN # 15SSEXF S/S

2. STONE WORKTOPS

3. TWIN BOWL SINK WITH TA

4. CABINETS AND TOP-BOX LOCKERS

5. COOKTOP:

GE LATEST MODEL

6. ICEMAKER:

GE LATEST MODEL

7. DOWNDRAFT VENTILATOR GE LATEST MODEL W/ LIGHT

8. DISHWASHER:

GE LATEST MODEL

9. OVEN:

GE BUILT IN LATEST MODEL

10. FULL HEIGHT REFRIGERATOR:

GE LATEST MODELS

11. FULL HEIGHT FREEZER:

GE LATEST MODELS

12. MICROWAVE:

GE LATEST MODEL

IX. HEADS

1. MARBLE COUNTER TOP AND LACQUER FINISH IN ALL HEADS
2. SEAMLESS POLYURETHANE FINISH IN ALL HEADS
3. NON-SLIDE MARBLE FLOORING SELECTED BY THE OWNER WITH HONEYCOMB BACKING
4. HEADHUNTER VACUUM TOILET SYSTEM IN EACH HEAD
5. EXHAUST FANS IN EACH HEAD
6. MIRROR CEILING WITH WOOD BORDERS IN EACH HEAD
7. SINKS WITH GROHE FAUCETS

X. REMARKS

Please note, this is an unbuilt new construction project which has not yet been started.

Listing broker has a list of popular options and prices, however, the standard equipment list above is very complete!

Completion time is approximately 14 months depending on other yard projects.

****OPTIONS UPON REQUEST****

****ALL SPECIFICATIONS SUBJECT TO CHANGE WITHOUT NOTICE**

COMMENT:

Since this is a new build offering, all photos are of previous projects. Exact layout, wood and stone selection are buyer's choice.

Disclaimer

Specifications are provided for informational purposes only. Data was obtained from sources believed reliable but is not guaranteed by owner or brokers. Buyer assumes responsibility to verify all speeds, capacities, consumption's and other measurements contained herein and otherwise provided and agrees to instruct his agents to confirm such details prior to purchase. Vessel is subject to prior sale, price and inventory changes and withdrawal from market without notice.

J92 Profile stbd night shot



J92 Profile with toys



Generated On 4/16/2026 10:34 PM by WORLD YACHT GROUP SVC Account

WORLD YACHT GROUP USA

WORLD YACHT GROUP SVC

JOHNSON 92 FLYBRIDGE

Account

**info160920210306@world-yacht-
group.com**

worldyachtgroup.com

J92 aerial view



J92 night stern shot



Generated On 4/16/2026 10:34 PM by WORLD YACHT GROUP SVC Account

WORLD YACHT GROUP USA

WORLD YACHT GROUP SVC

JOHNSON 92 FLYBRIDGE

Account

**info160920210306@world-yacht-
group.com**

worldyachtgroup.com

J92 Night shot



92 Profile



Generated On 4/16/2026 10:34 PM by WORLD YACHT GROUP SVC Account

WORLD YACHT GROUP USA

WORLD YACHT GROUP SVC

JOHNSON 92 FLYBRIDGE

Account

**info160920210306@world-yacht-
group.com**

worldyachtgroup.com

J92 aft port quarter



Generated On 4/16/2026 10:34 PM by WORLD YACHT GROUP SVC Account

WORLD YACHT GROUP USA

WORLD YACHT GROUP SVC

JOHNSON 92 FLYBRIDGE

Account

**info160920210306@world-yacht-
group.com**

worldyachtgroup.com

J92 Main deck owners cabin layout



Generated On 4/16/2026 10:34 PM by WORLD YACHT GROUP SVC Account

WORLD YACHT GROUP USA

WORLD YACHT GROUP SVC

JOHNSON 92 FLYBRIDGE

Account

**info160920210306@world-yacht-
group.com**

worldyachtgroup.com

Page 21 of 25

J92 Lower deck owners cabin layout



Generated On 4/16/2026 10:34 PM by WORLD YACHT GROUP SVC Account

WORLD YACHT GROUP USA

WORLD YACHT GROUP SVC

JOHNSON 92 FLYBRIDGE

Account

**info160920210306@world-yacht-
group.com**

worldyachtgroup.com

Page 22 of 25

J92 Upper deck layout



Generated On 4/16/2026 10:34 PM by WORLD YACHT GROUP SVC Account

WORLD YACHT GROUP USA

WORLD YACHT GROUP SVC

JOHNSON 92 FLYBRIDGE

Account

**info160920210306@world-yacht-
group.com**

worldyachtgroup.com

J92 Main deck country kitchen layout



Generated On 4/16/2026 10:34 PM by WORLD YACHT GROUP SVC Account

WORLD YACHT GROUP USA

WORLD YACHT GROUP SVC

JOHNSON 92 FLYBRIDGE

Account

**info160920210306@world-yacht-
group.com**

worldyachtgroup.com

Page 24 of 25

J92 Lower deck layout

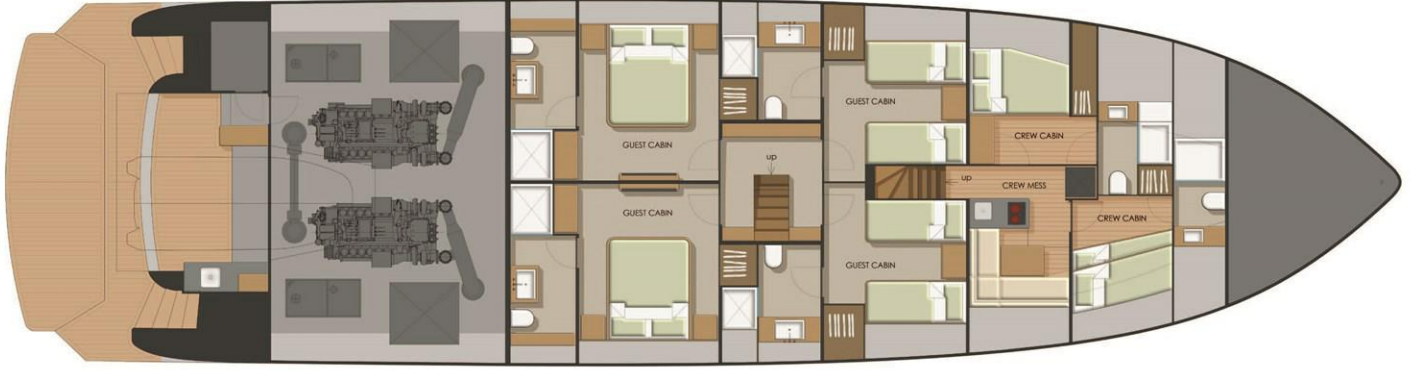

Generated On 4/16/2026 10:34 PM by WORLD YACHT GROUP SVC Account

WORLD YACHT GROUP USA

WORLD YACHT GROUP SVC

JOHNSON 92 FLYBRIDGE

Account

**info160920210306@world-yacht-
group.com**

worldyachtgroup.com