



VERPEKA DOLLING
SUPERYACHTS

Inace 135



LOA:	135' (41.15m)	Delivery/Model	2025
Beam:	27' 5" (8.36m)	Year:	
Tonnage:	0.00	Builder:	INACE
Speed:	12 Knots 15 Knots	Type:	Motor Yacht Expedition or Explorer
Flag:	Cayman	Staterooms:	6
Location:	Fortaleza, Ceara Brazil	Fuel Cap:	22500 Gal
VAT Paid:	No Duty Paid	Water Cap:	2950 Gal
		Engines:	2x, Caterpillar, C32, 1100 HP
		Price:	Price on Application

Generated On 5/18/2024 12:31 PM by VERPEKA DOLLING Yacht Brokerage SVC Account

VERPEKA DOLLING
Superyachts

VERPEKA DOLLING Yacht
Brokerage SVC Account
info261020210200@verpeka-
dolling-yacht-brokerage.com
www.verpeka.com

Inace 135

Page 1 of 13

Additional Specifications For Inace 135:

LOA:	135' (41.15m)	Delivery/Model	2025
Beam:	27' 5" (8.36m)	Year:	
Min Draft:	6' 5" (1.96m)	Year Built:	2025
Hull Material:	Steel	Builder:	INACE
Hull Config:	Full Displacement	Type:	Motor Yacht Expedition or Explorer
Hull Designer:	Overing Yacht Designs	Engines:	1100 HP,Twin, Inboard, Diesel, Caterpillar, C32,
Deck Material:	Steel	Staterooms:	6
Range At Cruise	7000	Sleeps:	12
Speed:		Heads:	8
Range At Max		Crew Quarters:	4
Speed:		Crew Berths:	8
Speed:	Cruising 12 Knots	Captain Cabin:	Yes
	Max 15 Knots	Classifications:	American Bureau of Shipping
Int Designer:	Kirschstein Designs Ltd.	MCA: Yes	ISM: No
Ext Designer:	Kirschstein designs Ltd.		
Fuel Capacity:	22500 Gal		
Water Capacity:	2950 Gal		
Flag:	Cayman		
Location:	Fortaleza, Ceara Brazil		
Price:	Price on Application		
Tax Status:	No Duty Paid		

Remarks

The new INACE 135' (41.2M) LONG RANGE MEGA MOTOR YACHT has the heart and soul of the proven INACE EXPLORER VESSELS. Essentially she is a world cruising ship dressed in Yacht Attire. She is designed to have a "yacht" feel with the efficiency and reliability of the aft house explorer vessels.

The 135' has a Kirschstein Design interior and exterior design. The high efficiency hull design was done by Overing Yacht Design, a recognized expert in this field. The vessel was tank tested in different sea states. In sea state 4 (8' 3" wave heights and wind speed of 27 knots) dead on the bow she has a 4000 plus nm range; at 10 knots she has a range of just under 6000 nm; in calm waters at 12 knots she has a range of 7000 nm, The hull was tested at over 15 knots. The 135 was not only created for efficiency but also to be seaworthy and sea kindly. Her moderate 7' draft allows her to enter harbors other vessels cannot while her outstanding use of space gives you the features of a much larger vessel.

The first in this series is under construction and has a upgraded interior done in paneled American cherry and custom moldings. The design incorporates large windows throughout the vessel creating stunning viewing areas and a light open feel to the interior.

A new construction takes approx 30 months.

@PAGEBREAK@

Specs.

Dimensions and Tolerances

Length Overall	41.2 meter	135.00 feet
Length Waterline	36.58 meters	120.00 feet
Beam, Maximum	8.28 meter	27.50 feet
Draft	2.2 meter	7.2 feet
Displacement Approx. full load	Mean	243.2 L tons
Fuel Oil Capacity, Approx.	85,500 liters	22,500 US gal.
Range @ 12.5 knots	6,000 NM	with reserve
Fresh Water Capacity, Approx.	11,020 liter	2,900 US gal.
Grey Water Capacity, Approx.	1,514 liter	400 US gal.
Black Water Capacity, Approx.	2,261 liter	600 US gal.
Main Engines (2) x C32 Caterpillar	Rated:	1100 hp @ 2100 rpm
Speed - Cruise	12.5 knots	
Speed - Max	15 knots	

Bulkheads - watertight Compartments

BULKHEADS – WATERTIGHT COMPARTMENTS

The vessel's hull is subdivided by transverse and longitudinal watertight and or oil tight bulkheads consist of the following compartments:

1. Forepeak
2. Fresh Water Tanks
3. Bow Thruster Compartment
4. Guest Stateroom Compartment
5. Master stateroom Compartment
6. Fuel Oil Tanks
7. Engine Room
8. Steering Gear Compartment

Deck Equipment

GROUND TACKLE EQUIPMENT – WINDLASS / CAPSTAN

The windlass and ground tackle has two Maxwell 8000 Lbs windlasses with 450' of 5/8" High tensile chain on each side (port and starboard) and 300 Kgs Navy type stainless steel anchors stored in two polished stainless steel anchor pockets located at port and starboard bow sides.

Capstans located on port and stb stern

HYDRAULIC PASSERELLE

The hydraulic passerelle installed in the aft port side of the vessel.

TENDER HANDLING

A 4000 PD hydraulic boom crane.

Flybridge

The flybridge space is large and very well laid out. Starting forward is a large curved forward facing bench seat for relaxing, reading and enjoying the view. There are large storage areas under the brow. Next aft is a large Jacuzzi with sun pads integrated into the design, with storage under , part of this area is covered by a hard top with a opening in the center above the Jacuzzi so it can be open to the sky or shaded as needed.

To either side of the Jacuzzi are large cabinets for work-out gear, next aft is a wonderful open space for sun chairs and tables with a full bar to stb and BBQ. Aft of this is a large lounge/ dining area that is built out on a balcony for wonderful views.

Generators

One NORTHERN LIGHTS 70 KW @ 1800 rpm, 380 V Three phase with double mount system, fiberglass sound shields and gas-water separators and One NORTHERN LIGHTS 50 KW generator with mounts and sound shields.

Both generators have Centek water wash and separator mufflers.

Safety And Fire Protection

A central fire alarm system is fitted and includes appropriate heat and/or smoke detectors in each of the accommodation spaces and the engine room. There are monitoring panels in the wheelhouse and crew mess that show the location of the fire with individual lights.

The fire and safety system meets both ABS and MCA requirements.

Tenders

The boat deck aft of the skylounge is designed to carry a 22' tender, a 15' tender and other toys.

MAIN ENGINES/MECHANICAL EQUIPMENT

The engine room is very large and well laid out in accordance with the needs of a worldwide explorer yacht. All equipment is arranged to be easily serviced. It is fully equipped to meet its mission profile as a far ranging vessel that will be operating with limited shore side back up in remote areas.

All sea water systems draw from the main sea chest system that consists of two sea chests with cross over pipe. The piping for all seawater will be CuNi. The chests can be cleaned while underway and incorporate a blow down system. Each chest can supply all raw water needs.

MAIN ENGINES:

Two (2) CATERPILLAR C32 1100hp @2100 rpm - B-rated

Exhaust system is Centek water wash and separator system.

REDUCTION GEARS AND/OR DRIVE UNITS

Two (2) **TWIN DISK** MG 6598DC reduction gears or similar, The gears to have power take off system with electric clutch to feed the Bow Thruster, windless and crane.

PROPELLERS

The propellers are a pair, one (1) R/H and one (1) L/H, Bronze, 5-blades

ENGINE CONTROLS

Kobelt controls, located in wheelhouse, wing stations and aft deck

BOW THRUSTER

20" **Quantum Hydraulics** - 100 HP

AIR CONDITIONING

Aqua Air Alpha Series. with fresh air makeup system

Additional drain pans have been added under the main compressor system and under each of the individual area handlers, all drain to the gray water system.

STABILIZER Quantum Hydraulics Zero Speed stabilizers

Generated On 5/18/2024 12:31 PM by VERPEKA DOLLING Yacht Brokerage SVC Account

VERPEKA DOLLING
Superyachts

VERPEKA DOLLING Yacht
Brokerage SVC Account
info261020210200@verpeka-
dolling-yacht-brokerage.com
www.verpeka.com

Inace 135

Page 6 of 13

FUEL OIL SYSTEM

An **ALFA LAVAL** fuel system model MIB 303 shall be installed.

RACOR filters (single filters for the generators,:

Two (2) RACOR fuel filters, Mod. 751000MAX30 for main engines. Generator RACOR to Mod. 1000MA30 single unit.

Sight gauges tank level to be placed adjacent to the tanks and fuel tank level monitors to be placed at the wheelhouse. Drip trays to be provided for all pumps, drains and fuel filters.

(1) Polished stainless steel retractable hose reel and ¾" PVC coated filling line to be provided near the engine room entry door for filling of tenders at the swim platform.

The fuel system will allow you to pump fuel from any tank to any tank via the main transfer system or through the Alfa Laval. There is also a 3rd back up dc system plus the main pump is integrated into the inverter system.

All major systems have back ups

Shore Power System

The vessel shall be equipped with Atlas conversion system.

Water Maker

Two water makers, 60 gal/hr each.

Black Water System

The water jet Headhunter toilet system

The USCG Certified Type II Marine Sanitation Device (MSD)

There is a large diaphragm pump for transfer from the black water tank to the MSD system or to the deck pump out. The gray water pump is interlinked to act as a back up.

The gray water system has a large diaphragm pump that is interlinked to the black water system.

FIRE, BILGE AND ANCHOR WASH

The bilge system includes two large bilge pumps, one (1) direct engine driven pump located in the E/R and one (1) 220 VAC electric pump located in the E/R, connected to the bilge manifold. The fire pump is interlinked to back up the bilge pump. In addition, there will be seven (7) submersible pumps, one in each compartment.

The fire system includes one large pump and the bilge pump is interlinked to the system.

In addition to these pumps there is a separate diesel driven self-priming emergency fire and bilge pump plumbed into the system per MCA requirements.

The engine room also has a fixed CO2 fire fighting system and portable extinguishers throughout the vessel per class requirements.

Fresh water system has two pumps that feed a common accumulator tank. There are 3 hot water tanks in the system. The system also has a direct deck pressure fitting.

There are two engine room fans which are both variable speed and reversible.

Decks

Teak Decks

Teak decking is bonded in epoxy glue or other adhesive. Work zones and flybridge are painted decks

Accommodations

The large 27.5' beam and full beam forward house design gives this Yacht Explorer huge volume for its length.

The incredible master stateroom starts just forward of midships on the main deck and is lined with large windows, which as in the rest of the boat create a light airy interior and stunning views. The master is a total of 770 sq. ft,

As on many 50m plus yachts you first enter into a private office/ library with desk and chairs and full office equipment. Next forward is the private study with TV, settee and wardrobe area, (there is a door from crew passage to service the master stateroom without intruding on the guest areas). Next forward you enter the full beam bedroom area. The windows and 27.5' expanse creates a wonderful environment for relaxing. To stb is a settee and to port are two chairs and table. On the forward bulkhead is an entertainment center, drawers and storage. Both sides of the stateroom are lined with storage. Forward of the bedroom are his and her heads, one with extra large shower and one with a Jacuzzi tub

To port and aft of the main bedroom is her walk in closet/dressing area with full length hanging lockers, large chest of drawers and a makeup area.

On the first in the series, when you first enter from the aft deck to the main saloon you will be instantly aware of the use of light from the windows to enhance the American cherry joinery. The saloon is separated from the dining area by an entertainment center.

The large fully equipped galley is to stb. The access to the comfortable crew area below and wheel house above is off the galley. There is also a side door for provisioning the vessel and crew movement to the deck from the galley.

The lower and upper guest areas and accessed off of the main lobby where the day head is located.

In the lower guest areas there are two queen staterooms aft off a lobby that has a guest refrigerator and extra laundry. Forward of the queen staterooms are two twin staterooms. To stb of the twins is the 5th guest stateroom that can be also separated and used as a pilot, guide, nanny, gym or other extra person's cabin giving you the option to have a total of 5 or 6 guest staterooms or the option to carry extra crew.

There is a door across from the sixth cabin that allows access for the crew to service the lower deck with a large laundry directly across from it. Forward of the laundry is a crew mess area and forward of this are two very comfortable double crew cabins with ensuite heads. In addition to these cabins there is also a engineers cabin located in the lazarette.

On the pilothouse deck the upper lobby has a day head forward and aft is a skylounge with extensive seating and entertainment area. To stb forward of the skylounge is a separate pantry for service to the skylounge and flybridge. Aft of the skylounge on the forward part of the boat deck is a covered seating area.

The forward part of the upper lobby leads to the crew landing with stairs coming up from the galley. Off the landing is the double bed captain's cabin and forward of this is a large wheelhouse with raised settee, radio and nav area and a well equipped bridge.

On the exterior of the deck forward of the wheelhouse is a large lounge and sunning area. There is extensive storage under the pads and seating. The foredeck has crew seating areas, large bosun's lockers, extra large chain lockers and room to carry toys.

Extensive work went into the design to ensure that the crew can work effectively without interaction with the guests unless they are required. They can move about the boat and provide full service without being intrusive in anyway.

Aft deck

The aft deck has a large table with seating for 10 to 12 guests, wet bar and storage. There is an entrance to the lazarette and engine room located on the stb side and port and stb stairs lead down to the good sized swim platform and door to the lazarette.

Audio And Visual Equipment

There is an allowance for Audio and Visual equipment

Captains Cabin

The captains cabin is quite large with ensuite head, double bed, desk and lots of storage.

It is located directly behind the wheelhouse.

Electronics and Navigational Equipment

There is an allowance for Electronics and Navigational equipment

Engineers Cabin

The engineer's cabin is located behind the engine room on the stb side and includes an ensuite head and two single beds.

Salon & Dining Area



Master Cabin



Generated On 5/18/2024 12:31 PM by VERPEKA DOLLING Yacht Brokerage SVC Account

VERPEKA DOLLING
Superyachts

VERPEKA DOLLING Yacht
Brokerage SVC Account
info261020210200@verpeka-
dolling-yacht-brokerage.com
www.verpeka.com

Inace 135

Page 10 of 13

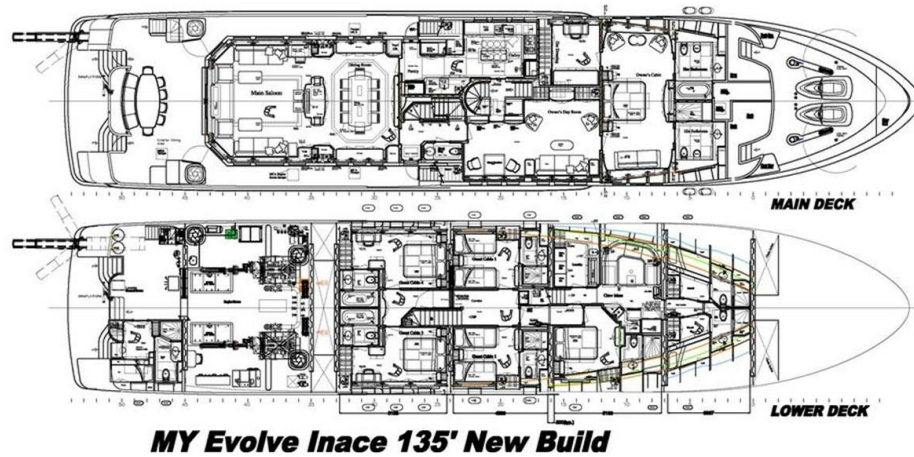
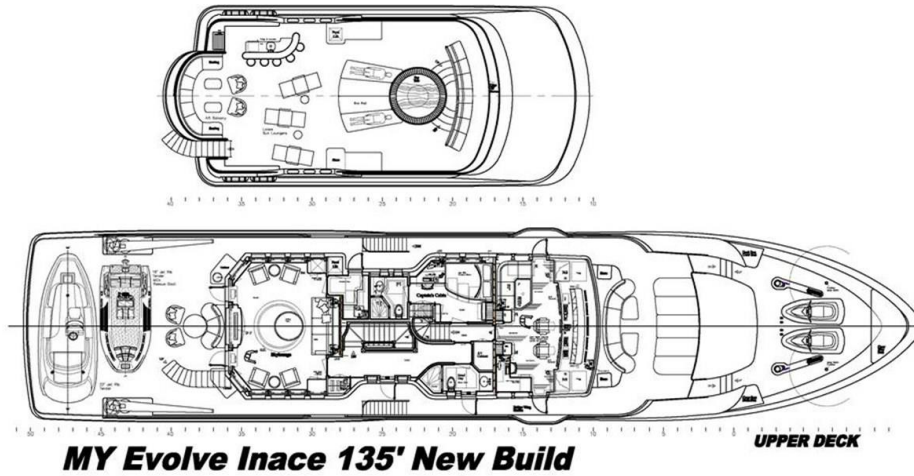

Generated On 5/18/2024 12:31 PM by VERPEKA DOLLING Yacht Brokerage SVC Account

VERPEKA DOLLING
Superyachts

VERPEKA DOLLING Yacht
Brokerage SVC Account
info261020210200@verpeka-
dolling-yacht-brokerage.com
www.verpeka.com

Inace 135

Page 11 of 13

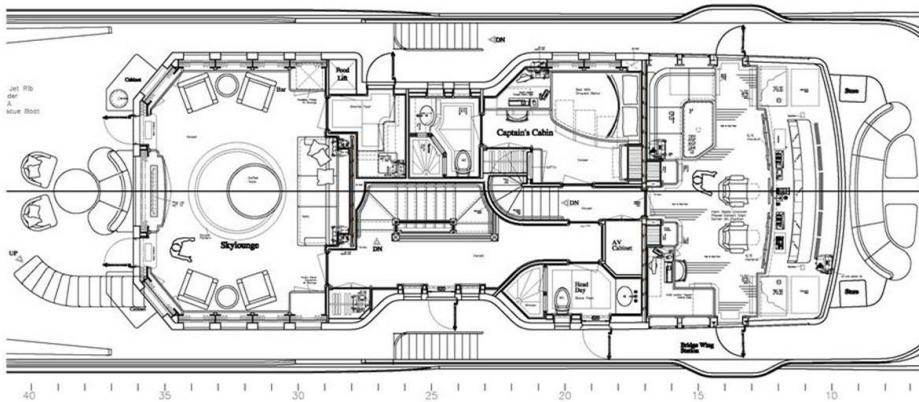
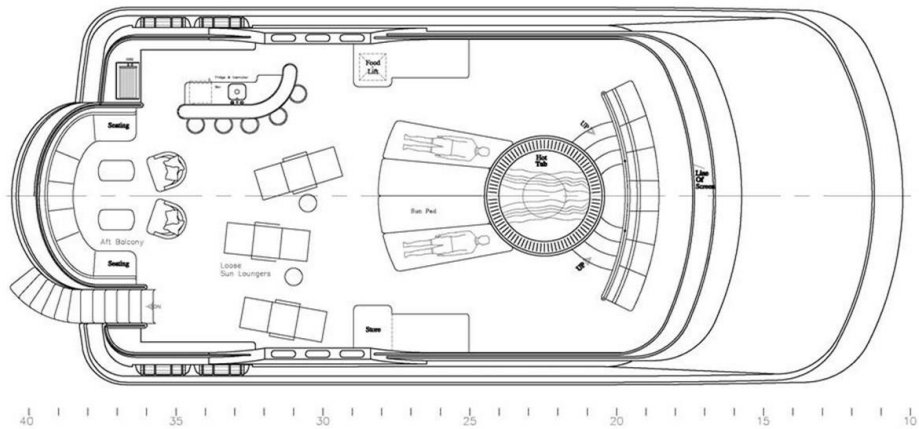

Generated On 5/18/2024 12:31 PM by VERPEKA DOLLING Yacht Brokerage SVC Account

VERPEKA DOLLING
Superyachts

VERPEKA DOLLING Yacht
Brokerage SVC Account
info261020210200@verpeka-
dolling-yacht-brokerage.com
www.verpeka.com

Inace 135

Page 12 of 13

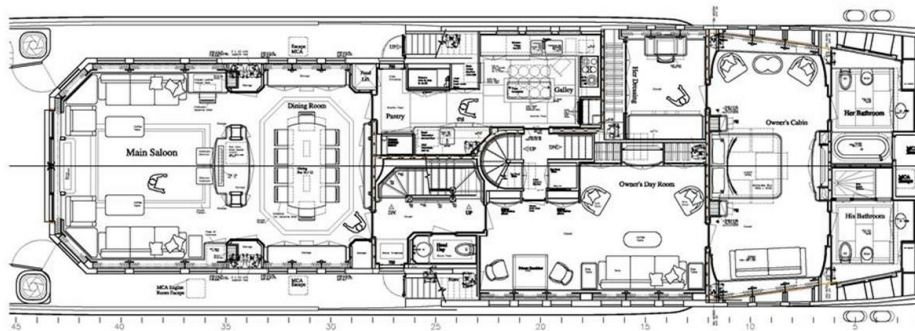

Generated On 5/18/2024 12:31 PM by VERPEKA DOLLING Yacht Brokerage SVC Account

VERPEKA DOLLING
Superyachts

VERPEKA DOLLING Yacht
Brokerage SVC Account
info261020210200@verpeka-
dolling-yacht-brokerage.com
www.verpeka.com

Inace 135

Page 13 of 13