



world yacht group

Experts in luxury yachts

Los Angeles | Cannes | Madrid | Barcelona | Athens | Belgrade

All Ocean Yachts Overing 100' Explorer



LOA:	100' 1" (30.51m)	Delivery/Model	2025
Beam:	25' 11" (7.9m)	Year:	
Max Draft:	7' 11" (2.41m)	Model:	AOYO 100
Tonnage:	0.00	Builder:	ALL OCEAN YACHTS
Speed:	10 Knots 14 Knots	Type:	Motor Yacht
Flag:	N/A	Staterooms:	4
Location:	N/A, Florida United States	Fuel Cap:	10000 Gal
VAT Paid:	No Duty Paid	Water Cap:	1500 Gal
		Engines:	1x, Caterpillar, C18 Acert, 715 HP
		Price:	\$9,195,000 USD

Generated On 6/2/2023 2:00 PM by WORLD YACHT GROUP SVC Account

WORLD YACHT GROUP

WORLD YACHT GROUP SVC
Account
info160920210306@world-yacht-
group.com
worldyachtgroup.com

All Ocean Yachts Overing 100'
Explorer

Page 1 of 9

Additional Specifications For All Ocean Yachts Overing 100' Explorer :

LOA:	100' 1" (30.51m)	Delivery/Model	2025
Beam:	25' 11" (7.9m)	Year:	
Max Draft:	7' 11" (2.41m)	Year Built:	2025
Hull Material:	Composite Fiberglass	Builder:	ALL OCEAN YACHTS
Hull Config:	Displacement w/ Bulbous Bow	Model:	AOYO 100
Deck Material:	Teak over Fiberglass	Type:	Motor Yacht
Range At Cruise	7000	Top:	Raised Pilothouse
Speed:		Engines:	715 HP, Single, Inboard, Diesel, Caterpillar, C18 Acert,
Speed:	Cruising 10 Knots	Staterooms:	4
	Max 14 Knots	Sleeps:	8
Int Designer:	Espinosa Inc	Heads:	4
Ext Designer:	Overing Yacht Design	Crew Quarters:	3
Fuel Capacity:	10000 Gal	Crew Berths:	4
Water Capacity:	1500 Gal	Captain Cabin:	Yes
Holding Tank:	264 Gal	Classifications:	Lloyd's 100A1 maltese
Flag:	N/A	MCA: Yes	ISM:
Location:	N/A, Florida United States		
Price:	\$9,195,000 USD		
Tax Status:	No Duty Paid		

Generated On 6/2/2023 2:00 PM by WORLD YACHT GROUP SVC Account

WORLD YACHT GROUP

WORLD YACHT GROUP SVC
Account
info160920210306@world-yacht-
group.com
worldyachtgroup.com

All Ocean Yachts Overing 100'
Explorer
Page 2 of 9

Introduction

The All Ocean Yachts Overing Explorer Yachts are based on the proven high efficiency full displacement hull form created by Overing Yacht Design, a recognized leader in this type of hull. The hull form allows the All Ocean Yachts' Overing line to cruise using very small amounts of fuel and increased speeds for a given RPM. This greatly reduces the overall operating cost of the vessel.

The design was created for worldwide travel and cruising in remote areas with little or no shore support for long periods of time.

The large volume created by the Overing design gives it the room to carry all of the equipment and supplies needed for world cruising.

The volume also allows all of the All Ocean Yachts' Overing design line of yachts to have a very unique feature. They have a full height deck forward below the normal lower accommodations deck. This area is accessed via a door and stairs. This deck contains a nice laundry area, extra refrigerators and freezers and a lot of dry good storage.

Forward of the storage area is a pump room with the fresh water pumps, two water makers, water heaters and water filters. Note there is a third water heater for the crew area.

The exceptional flybridge layout not only has comfortable seating and all of the amenities you would expect but she also carries a larger then normal tender for a vessel of her size.

When compared against other vessels in their size range the All Ocean Yachts' Overing 100' stands out as a serious cruising yacht with exceptional features that few can match.

General Specifications

- LOA 100'-0"
- Beam 25'-6"
- Draft 7'-6"
- Highly Efficient Round Bilge Bulbous Bow Hull
- Displacement 190 LT Approx.
- Fuel Tankage 10,000 gals.
- Water Tankage 1,500 gals.
- Grey Water Tankage 400 gals.
- Black Water Tankage 600 gals.
- Dirty/Lube Oil Tankage 100 gals.
- Naval Architecture & Design: Overing Yacht Designs
- Interior Design: Espinosa Inc. or Owner Choice
- Sound Engineering: Soundown Inc. or Equal

Construction

Solid Laminate Infused Vinylester Hull
Foam Cored Vinylester Infused Superstructure
High Quality Awlgrip Finish
Classed RINA/MCA LY2
Five (5) Watertight Compartments

Generated On 6/2/2023 2:00 PM by WORLD YACHT GROUP SVC Account

WORLD YACHT GROUP

WORLD YACHT GROUP SVC
Account
info160920210306@world-yacht-
group.com
worldyachtgroup.com

All Ocean Yachts Overing 100'
Explorer
Page 3 of 9

Engine Room & Major Equipment

(2) Cat C18 Acert, 715HP Max Cont "C" Rating
(2) Twin Disc MGX 5114 DC
Twin Disc single lever controls
Custom Water Drop Exhaust System
(2) 55kW Northern Lights Generators w/InSep
Racor Fuel/Water Filters
Alpha Laval Fuel Centrifuge
Fuel Transfer System
Bilge System/Fire Fighting System
Headhunter MSD
Fire Extinguishing System
Hydraulic Bow Thruster
TRAC "STAR"Hydraulic Stabilizers
Kobelt Hydraulic Steering
(2) Air Compressors
(2) Freshwater pressure sets
(2) 1,200 gal/day watermaker
(3) Hot water heaters
Aqua Air AC/heat system
Atlas Transformer
Battery Chargers
Engine Room Blower System
Air Cond. Eng.Rm. & Mach. Space
All deck hardware 316L Stainless Steel
(2) Maxwell 6000 Anchor Windlasses
(2) Maxwell 4000 Warping Capstans
Stainless Anchor Pocket & (2)185KG SHHP Anchors W/300 ft. 5/8" Stud Link Chain P/S
Coast Guard approved Safety Equipment
Hydraulic Passerelle

Master Stateroom & Bath

- Full King size bed
- Built in nightstands & dresser
- Cedar lined closets w/lights
- Built in EntertainmentCenter w/43" LCD TV
- Fixed Windows
- Built in settee
- His and Hers Custom Vanities
- Marble tops w/Lav. Bowls
- Headhunter Toilets
- Oversized stall shower
- Exhaust fan system
- Custom Mirrors
- Lighting recessed in ceiling
- AC/heat system w/digital controls
- Floor & wall coverings

Generated On 6/2/2023 2:00 PM by WORLD YACHT GROUP SVC Account

WORLD YACHT GROUP

WORLD YACHT GROUP SVC
Account
info160920210306@world-yacht-
group.com
worldyachtgroup.com

All Ocean Yachts Overing 100'
Explorer
Page 4 of 9

Guest Staterooms & Bath

- One Queen, & One Twin cabin
- Built in nightstands & dresser
- Cedar lined closets w/lights
- Drawer space built in under beds
- Built in Entertainment Center w/22" LCD TV
- Opening Portlights
- Custom Vanities w/mirrors
- Marble tops w/Lav. Bowls
- Headhunter Toilet
- Shower
- Exhaust fan system
- Lighting recessed in ceiling
- AC/heat system w/digital controls
- Floor & wall coverings

Captain's Cabin

- Double bed
- Built in nightstands & dresser
- Cedar lined closets w/lights
- Drawer space built in under beds
- Built in Entertainment Center w/22" LCD TV
- Built in Desk
- Fixed Portlight
- Custom Vanities w/mirrors
- Corian tops w/Lav. Bowl
- Headhunter Toilet
- Oversized stall shower
- Exhaust fan system
- Lighting recessed in ceiling
- AC/heat system w/digital controls
- Floor & wall coverings

Crew Quarters

- One stateroom for Two crew
- Cedar lined closets w/lights
- Headhunter Toilet

Crew Galley

- Soaking Sink
- Washer & Dryer

Crew Lounge

- Built in settee
- Built in Entertainment Center w/22" LCD TV

Aft Main Deck

- Custom Built in Seating w/ tables & loose chairs supplied by Owner
- Custom Built-in Bar w/Soaking Sink, Refrig. & Ice Machine

Generated On 6/2/2023 2:00 PM by WORLD YACHT GROUP SVC Account

WORLD YACHT GROUP

WORLD YACHT GROUP SVC
Account
info160920210306@world-yacht-
group.com
worldyachtgroup.com

All Ocean Yachts Overing 100'

Explorer

Page 5 of 9

Main Salon

- Loose Furniture supplied by Owner
- Built in Entertainment Center w/43" LCD TV
- Lighting recessed in ceiling
- AC/heat system w/digital controls
- Floor & wall coverings

Formal Dining

- Dining Table & Chairs supplied by Owner.
- Fore & Aft China Cabinets
- Lighting recessed in ceiling
- AC/heat system w/digital controls
- Floor & wall coverings

Main Lobby & Powder Room

- Coat locker
- Powder Room Vanity w/mirror
- Granite tops w/Lav. Bowl
- Head Hunter Toilet
- Exhaust fan system
- Floor & wall coverings

Galley

- Custom mica cabinets & Corian tops
- Refrig/Freezer w/ ice & water dispenser
- (2) Self cleaning ovens
- Microwave oven
- Dishwasher
- Trash Compactor
- Food Lift
- Surface range w/exhaust hood
- Double Stainless sink w/disposal
- Undercounter & overhead lighting
- Two Pantries
- AC/heat system w/digital controls
- Floor & wall coverings

Pilothouse

- Custom padded control console w/elevated helm station
- Separate navigation center
- Full instrumentation
- Recaro Helm chair
- Custom elevated settee & table
- \Five windshield wipers/washers
- Built in chart drawers
- Recessed white & red lighting & ceiling
- AC/heat system w/digital controls
- Floor & wall coverings
- Custom Safety Panel & Monitoring System

Generated On 6/2/2023 2:00 PM by WORLD YACHT GROUP SVC Account

WORLD YACHT GROUP

WORLD YACHT GROUP SVC
Account
info160920210306@world-yacht-
group.com
worldyachtgroup.com

All Ocean Yachts Overing 100'
Explorer
Page 6 of 9

Boat Deck

- Chocks for Owner-furnished 19' & 12' Tender
- (1) 3000 lb. Hydraulic Crane

Flybridge

- Custom Canopy & Mast
- Custom Bar w/6 stools, Refrig/Freezer & Stainless grill
- Custom seating w/cushions & Buffet

Teak Decks

- Swim Platform, Main Deck, 01 & 02 Decks shall be covered w/Burma Teak

Tenders

Chocks for owner-furnished 19' and 12' Tenders
1 3000 lb hydraulic crane

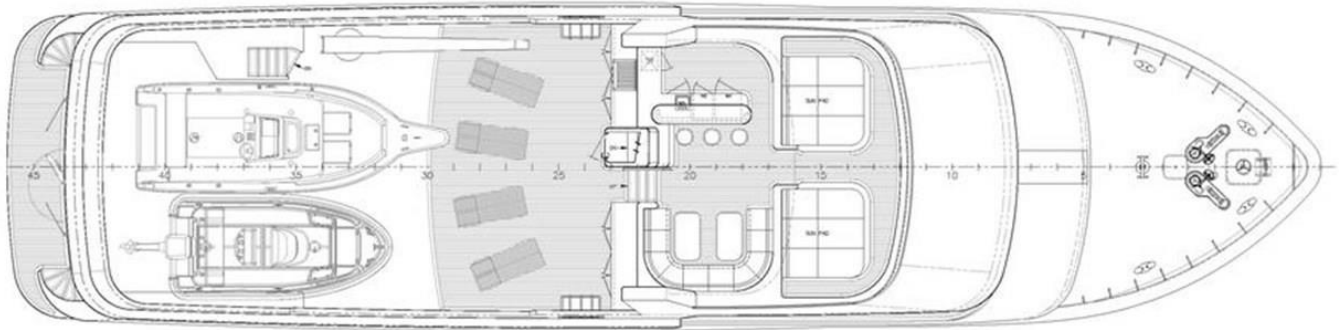

01 DECK & FLYBRIDGE

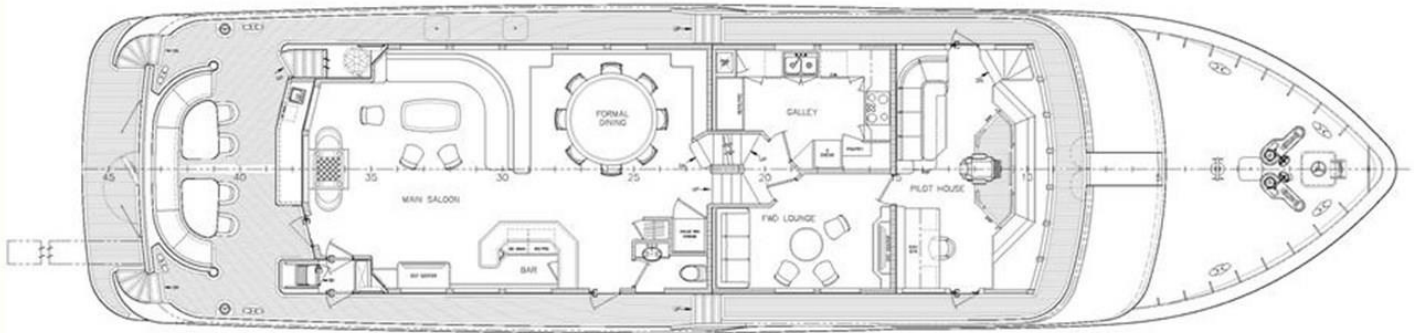

MAIN DECK

DAUNTLESS

The Explorer's EXPLORER[®]

D100

This drawing, design concept, and specifications are the exclusive property of OVERING YACHT DESIGNS, LLC. It is to be used only for the purposes intended and may not be reproduced, copied, or used in any way without the express written permission of OVERING YACHT DESIGNS, LLC. The recipient hereby agrees not to disclose these contents herein to any other party without the express written permission of OVERING YACHT DESIGNS, LLC.

SCALE: 1/4" = 1'-0"
 DATE: 10/22/2011
 DRAWN BY: JPL/JCH
 CHECKED BY: JPD
 REV: 1

100'-0" x 25'-6" x 7'-6"
 PILOT HOUSE EXPLORER
 GENERAL ARRANGEMENTS

APPROVALS
 BUILDER _____
 CLASS _____

OVERING YACHT DESIGNS, LLC
 18170 Oak St., Coast Station, NE 1388
 Ft. Lauderdale, FL 33309
 WWW.OVERINGYACHTDESIGNS.COM TEL: 754.270.9999

Generated On 6/2/2023 2:00 PM by WORLD YACHT GROUP SVC Account

WORLD YACHT GROUP

WORLD YACHT GROUP SVC

All Ocean Yachts Overing 100'

Account

Explorer

info160920210306@world-yacht-group.com

Page 8 of 9

worldyachtgroup.com

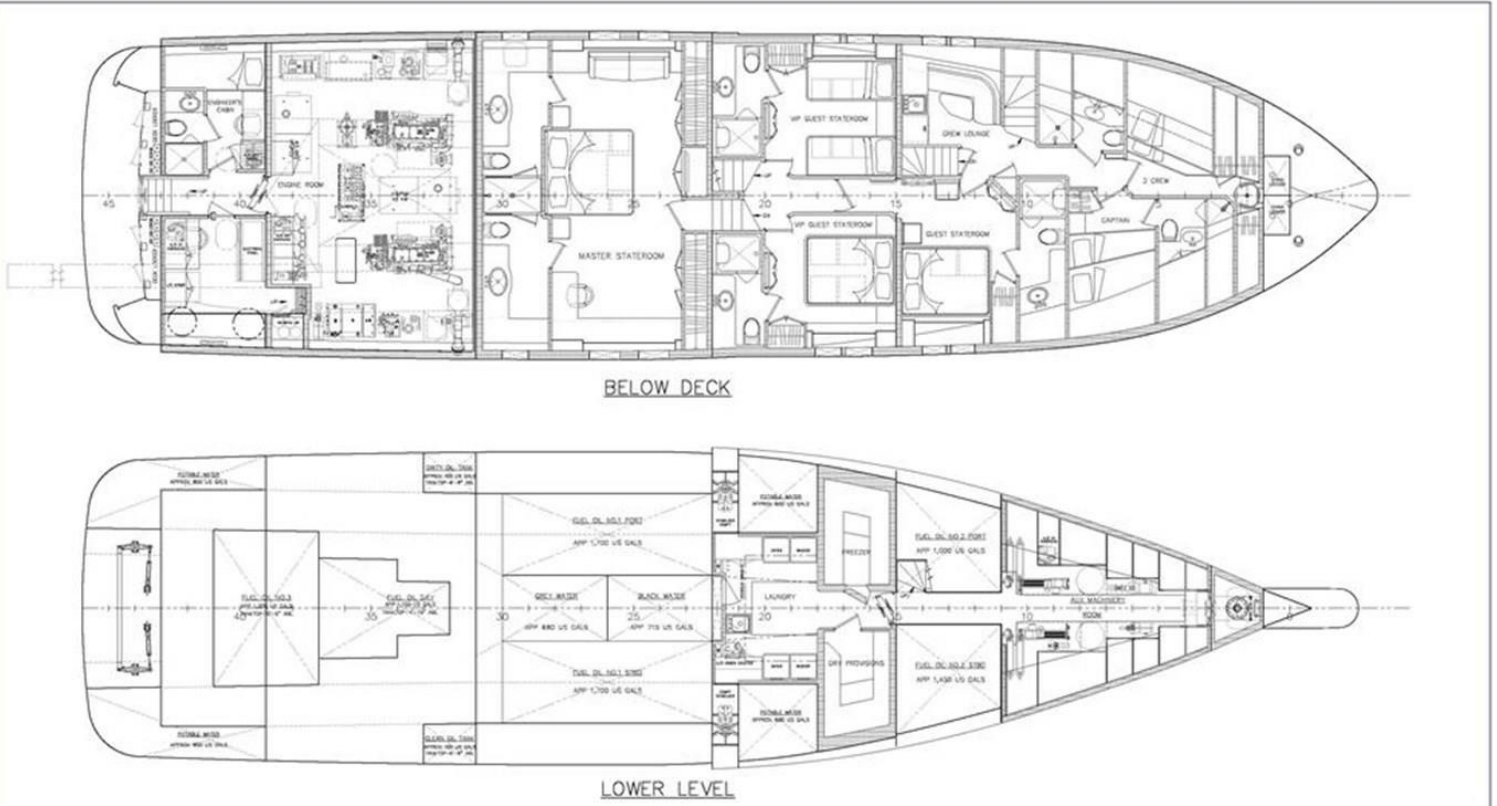

DAUNTLESS

The Explorer's EXPLORER[®]

D100

The drawing, design concept, and specifications are the exclusive property of OVERING YACHT DESIGNS, LLC. They shall not be copied, reproduced, or used in any manner, without the express written permission of the designer. The recipient hereby agrees not to disclose these contents herein to any other party without the express written permission of the designer.

SCALE: 1:60	DATE: 10/20/11	DWG NO: 021-1
DRAWN BY: JPD	CHKD BY: JPD	SW: 1 OF 1
SHEET NO: 1	JOB NO: 0308	REV: 1

100'-0" x 25'-6" x 7'-6"
PILOT HOUSE EXPLORER
OUTBOARD PROFILE

APPROVALS

BYD: _____ BUILDER: _____

OWNER: _____ CLASS: _____

OVERING YACHT DESIGNS, LLC
1817 Ocean Blvd., Ocean Springs, MS 38858
Tel: 662-893-3333
Web: www.oringyacht.com

INTERNATIONAL YACHT AND SHIP DESIGN SINCE 1969

Generated On 6/2/2023 2:00 PM by WORLD YACHT GROUP SVC Account

WORLD YACHT GROUP

WORLD YACHT GROUP SVC

All Ocean Yachts Overing 100'

Account

Explorer

info160920210306@world-yacht-

Page 9 of 9

group.com

worldyachtgroup.com