



world yacht group

Experts in luxury yachts

## All Ocean Yachts Overing 100' Explorer



**LOA:** 100' 1" (30.5m)  
**Beam:** 25' 11" (7.9m)  
**Max Draft:** 7' 11" (2.41m)  
**Tonnage:** 0.00  
**Speed:** 10 Knots  
14 Knots  
**Flag:** N/A  
**Location:** N/A, Florida  
United States  
**VAT Paid:** No Duty Paid

**Delivery/Model** 2027  
**Year:**  
**Model:** AOYO 100  
**Builder:** ALL OCEAN YACHTS  
**Type:** Motor Yacht  
**Staterooms:** 4  
**Fuel Cap:** 10000 Gal  
**Water Cap:** 1500 Gal  
**Engines:** 1x, Caterpillar, C18 Acert,  
715 HP  
**Price:** \$9,195,000 USD

Generated On 5/9/2025 5:27 AM by WORLD YACHT GROUP SVC Account

**WORLD YACHT GROUP USA**

**WORLD YACHT GROUP SVC**  
**Account**  
**info160920210306@world-yacht-**  
**group.com**  
**worldyachtgroup.com**

**All Ocean Yachts Overing 100'**  
**Explorer**

Page 1 of 9

## Additional Specifications For All Ocean Yachts Overing 100' Explorer :

<b>LOA:</b>	100' 1" (30.5m)	<b>Delivery/Model</b>	2027
<b>Beam:</b>	25' 11" (7.9m)	<b>Year:</b>	
<b>Max Draft:</b>	7' 11" (2.41m)	<b>Year Built:</b>	2027
<b>Hull Material:</b>	Composite Fiberglass	<b>Builder:</b>	ALL OCEAN YACHTS
<b>Hull Config:</b>	Displacement w/ Bulbous Bow	<b>Model:</b>	AOYO 100
<b>Deck Material:</b>	Teak over Fiberglass	<b>Type:</b>	Motor Yacht
<b>Range At Cruise</b>	7000	<b>Top:</b>	Raised Pilothouse
<b>Speed:</b>		<b>Engines:</b>	715 HP, Single, Inboard, Diesel, Caterpillar, C18 Acert,
<b>Range At Max</b>		<b>Staterooms:</b>	4
<b>Speed:</b>		<b>Sleeps:</b>	8
<b>Speed:</b>	Cruising 10 Knots	<b>Heads:</b>	4
	Max 14 Knots	<b>Crew Quarters:</b>	3
<b>Int Designer:</b>	Espinosa Inc	<b>Crew Berths:</b>	4
<b>Ext Designer:</b>	Overing Yacht Design	<b>Captain Cabin:</b>	Yes
<b>Fuel Capacity:</b>	10000 Gal	<b>Classifications:</b>	Lloyd's 100A1 maltese
<b>Water Capacity:</b>	1500 Gal	<b>MCA:</b>	Yes
<b>Holding Tank:</b>	264 Gal	<b>ISM:</b>	
<b>Flag:</b>	N/A		
<b>Location:</b>	N/A, Florida		
	United States		
<b>Price:</b>	\$9,195,000 USD		
<b>Tax Status:</b>	No Duty Paid		

## **Introduction**

The All Ocean Yachts Overing Explorer Yachts are based on the proven high efficiency full displacement hull form created by Overing Yacht Design, a recognized leader in this type of hull. The hull form allows the All Ocean Yachts' Overing line to cruise using very small amounts of fuel and increased speeds for a given RPM. This greatly reduces the overall operating cost of the vessel.

The design was created for worldwide travel and cruising in remote areas with little or no shore support for long periods of time.

The large volume created by the Overing design gives it the room to carry all of the equipment and supplies needed for world cruising.

The volume also allows all of the All Ocean Yachts' Overing design line of yachts to have a very unique feature. They have a full height deck forward below the normal lower accommodations deck. This area is accessed via a door and stairs. This deck contains a nice laundry area, extra refrigerators and freezers and a lot of dry good storage.

Forward of the storage area is a pump room with the fresh water pumps, two water makers, water heaters and water filters. Note there is a third water heater for the crew area.

The exceptional flybridge layout not only has comfortable seating and all of the amenities you would expect but she also carries a larger then normal tender for a vessel of her size.

When compared against other vessels in their size range the All Ocean Yachts' Overing 100' stands out as a serious cruising yacht with exceptional features that few can match.

## **General Specifications**

- LOA 100'-0"
- Beam 25'-6"
- Draft 7'-6"
- Highly Efficient Round Bilge Bulbous Bow Hull
- Displacement 190 LT Approx.
- Fuel Tankage 10,000 gals.
- Water Tankage 1,500 gals.
- Grey Water Tankage 400 gals.
- Black Water Tankage 600 gals.
- Dirty/Lube Oil Tankage 100 gals.
- Naval Architecture & Design: Overing Yacht Designs
- Interior Design: Espinosa Inc. or Owner Choice
- Sound Engineering: Soundown Inc. or Equal

## **Construction**

Solid Laminate Infused Vinylester Hull  
Foam Cored Vinylester Infused Superstructure  
High Quality Awlgrip Finish  
Classed RINA/MCA LY2  
Five (5) Watertight Compartments

## **Engine Room & Major Equipment**

(2) Cat C18 Acert, 715HP Max Cont "C" Rating  
(2) Twin Disc MGX 5114 DC  
Twin Disc single lever controls  
Custom Water Drop Exhaust System  
(2) 55kW Northern Lights Generators w/InSep  
Racor Fuel/Water Filters  
Alpha Laval Fuel Centrifuge  
Fuel Transfer System  
Bilge System/Fire Fighting System  
Headhunter MSD  
Fire Extinguishing System  
Hydraulic Bow Thruster  
TRAC "STAR" Hydraulic Stabilizers  
Kobelt Hydraulic Steering  
(2) Air Compressors  
(2) Freshwater pressure sets  
(2) 1,200 gal/day watermaker  
(3) Hot water heaters  
Aqua Air AC/heat system  
Atlas Transformer  
Battery Chargers  
Engine Room Blower System  
Air Cond. Eng.Rm. & Mach. Space  
All deck hardware 316L Stainless Steel  
(2) Maxwell 6000 Anchor Windlasses  
(2) Maxwell 4000 Warping Capstans  
Stainless Anchor Pocket & (2)185KG SHHP Anchors W/300 ft. 5/8" Stud Link Chain P/S  
Coast Guard approved Safety Equipment  
Hydraulic Passerelle

## **Master Stateroom & Bath**

- Full King size bed
- Built in nightstands & dresser
- Cedar lined closets w/lights
- Built in Entertainment Center w/43" LCD TV
- Fixed Windows
- Built in settee
- His and Hers Custom Vanities
- Marble tops w/Lav. Bowls
- Headhunter Toilets
- Oversized stall shower
- Exhaust fan system
- Custom Mirrors
- Lighting recessed in ceiling
- AC/heat system w/digital controls
- Floor & wall coverings

### **Guest Staterooms & Bath**

- One Queen, & One Twin cabin
- Built in nightstands & dresser
- Cedar lined closets w/lights
- Drawer space built in under beds
- Built in Entertainment Center w/22" LCD TV
- Opening Portlights
- Custom Vanities w/mirrors
- Marble tops w/Lav. Bowls
- Headhunter Toilet
- Shower
- Exhaust fan system
- Lighting recessed in ceiling
- AC/heat system w/digital controls
- Floor & wall coverings

### **Captain's Cabin**

- Double bed
- Built in nightstands & dresser
- Cedar lined closets w/lights
- Drawer space built in under beds
- Built in Entertainment Center w/22" LCD TV
- Built in Desk
- Fixed Portlight
- Custom Vanities w/mirrors
- Corian tops w/Lav. Bowl
- Headhunter Toilet
- Oversized stall shower
- Exhaust fan system
- Lighting recessed in ceiling
- AC/heat system w/digital controls
- Floor & wall coverings

### **Crew Quarters**

- One stateroom for Two crew
- Cedar lined closets w/lights
- Headhunter Toilet

### **Crew Galley**

- Soaking Sink
- Washer & Dryer

### **Crew Lounge**

- Built in settee
- Built in Entertainment Center w/22" LCD TV

### **Aft Main Deck**

- Custom Built in Seating w/ tables & loose chairs supplied by Owner
- Custom Built-in Bar w/Soaking Sink, Refrig. & Ice Machine

Generated On 5/9/2025 5:27 AM by WORLD YACHT GROUP SVC Account

**WORLD YACHT GROUP USA**

**WORLD YACHT GROUP SVC**  
**Account**  
**info160920210306@world-yacht-**  
**group.com**  
**worldyachtgroup.com**

**All Ocean Yachts Overing 100'**  
**Explorer**  
Page 5 of 9

### **Main Salon**

- Loose Furniture supplied by Owner
- Built in Entertainment Center w/43" LCD TV
- Lighting recessed in ceiling
- AC/heat system w/digital controls
- Floor & wall coverings

### **Formal Dining**

- Dining Table & Chairs supplied by Owner.
- Fore & Aft China Cabinets
- Lighting recessed in ceiling
- AC/heat system w/digital controls
- Floor & wall coverings

### **Main Lobby & Powder Room**

- Coat locker
- Powder Room Vanity w/mirror
- Granite tops w/Lav. Bowl
- Head Hunter Toilet
- Exhaust fan system
- Floor & wall coverings

### **Galley**

- Custom mica cabinets & Corian tops
- Refrig/Freezer w/ ice & water dispenser
- (2) Self cleaning ovens
- Microwave oven
- Dishwasher
- Trash Compactor
- Food Lift
- Surface range w/exhaust hood
- Double Stainless sink w/disposal
- Undercounter & overhead lighting
- Two Pantries
- AC/heat system w/digital controls
- Floor & wall coverings

### **Pilothouse**

- Custom padded control console w/elevated helm station
- Separate navigation center
- Full instrumentation
- Recaro Helm chair
- Custom elevated settee & table
- \Five windshield wipers/washers
- Built in chart drawers
- Recessed white & red lighting & ceiling
- AC/heat system w/digital controls
- Floor & wall coverings
- Custom Safety Panel & Monitoring System

Generated On 5/9/2025 5:27 AM by WORLD YACHT GROUP SVC Account

**WORLD YACHT GROUP USA**

**WORLD YACHT GROUP SVC**

**All Ocean Yachts Overing 100'**

**Account**

**Explorer**

**info160920210306@world-yacht-**

Page 6 of 9

**group.com**

**worldyachtgroup.com**

### **Boat Deck**

- Chocks for Owner-furnished 19' & 12' Tender
- (1) 3000 lb. Hydraulic Crane

### **Flybridge**

- Custom Canopy & Mast
- Custom Bar w/6 stools, Refrig/Freezer & Stainless grill
- Custom seating w/cushions & Buffet

### **Teak Decks**

- Swim Platform, Main Deck, 01 & 02 Decks shall be covered w/Burma Teak

### **Tenders**

Chocks for owner-furnished 19' and 12' Tenders  
1 3000 lb hydraulic crane

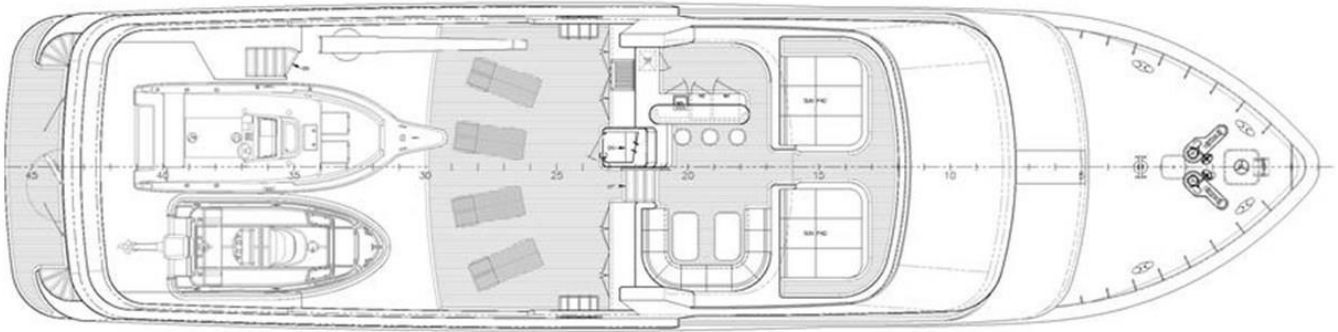

01 DECK & FLYBRIDGE

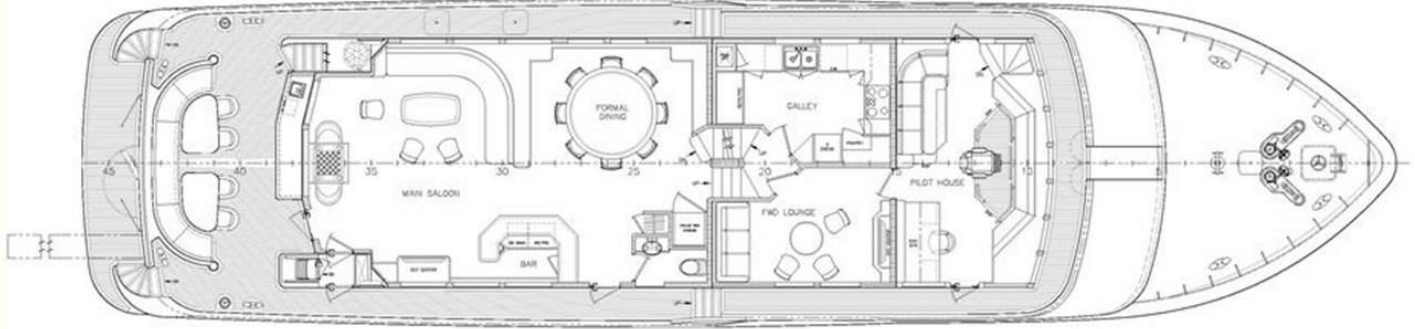

MAIN DECK

**DAUNTLESS**

# The Explorer's EXPLORER<sup>®</sup>

D100

This drawing, design concept, and specifications are the exclusive property of OVERING YACHT DESIGNS, LLC. They are to be used only for the purpose of obtaining a building permit and are not to be used for any other purpose without the written consent of OVERING YACHT DESIGNS, LLC. Any reproduction or use of this drawing without the written consent of OVERING YACHT DESIGNS, LLC is strictly prohibited.

SCALE: 1/4" = 1'-0"  
DATE: 10/22/2011  
DRAWN BY: JPL/CH  
CHKD BY: JPD  
REV: 1

100'-0" x 25'-6" x 7'-6"  
PILOT HOUSE EXPLORER  
GENERAL ARRANGEMENTS

APPROVALS  
BYD: \_\_\_\_\_  
OWNER: \_\_\_\_\_  
BUILDER: \_\_\_\_\_  
CLASS: \_\_\_\_\_

**OVERING YACHT DESIGNS, LLC**  
18171 10th St., Overing, OH 44130  
Tel: 216.293.1000  
Fax: 216.293.1001  
www.oringyacht.com  
INTERNATIONAL YACHT AND SHIP DESIGN SINCE 1969

Generated On 5/9/2025 5:27 AM by WORLD YACHT GROUP SVC Account

**WORLD YACHT GROUP USA**

**WORLD YACHT GROUP SVC**

**All Ocean Yachts Overing 100'**

**Account**

**Explorer**

**info160920210306@world-yacht-**

Page 8 of 9

**group.com**

**worldyachtgroup.com**

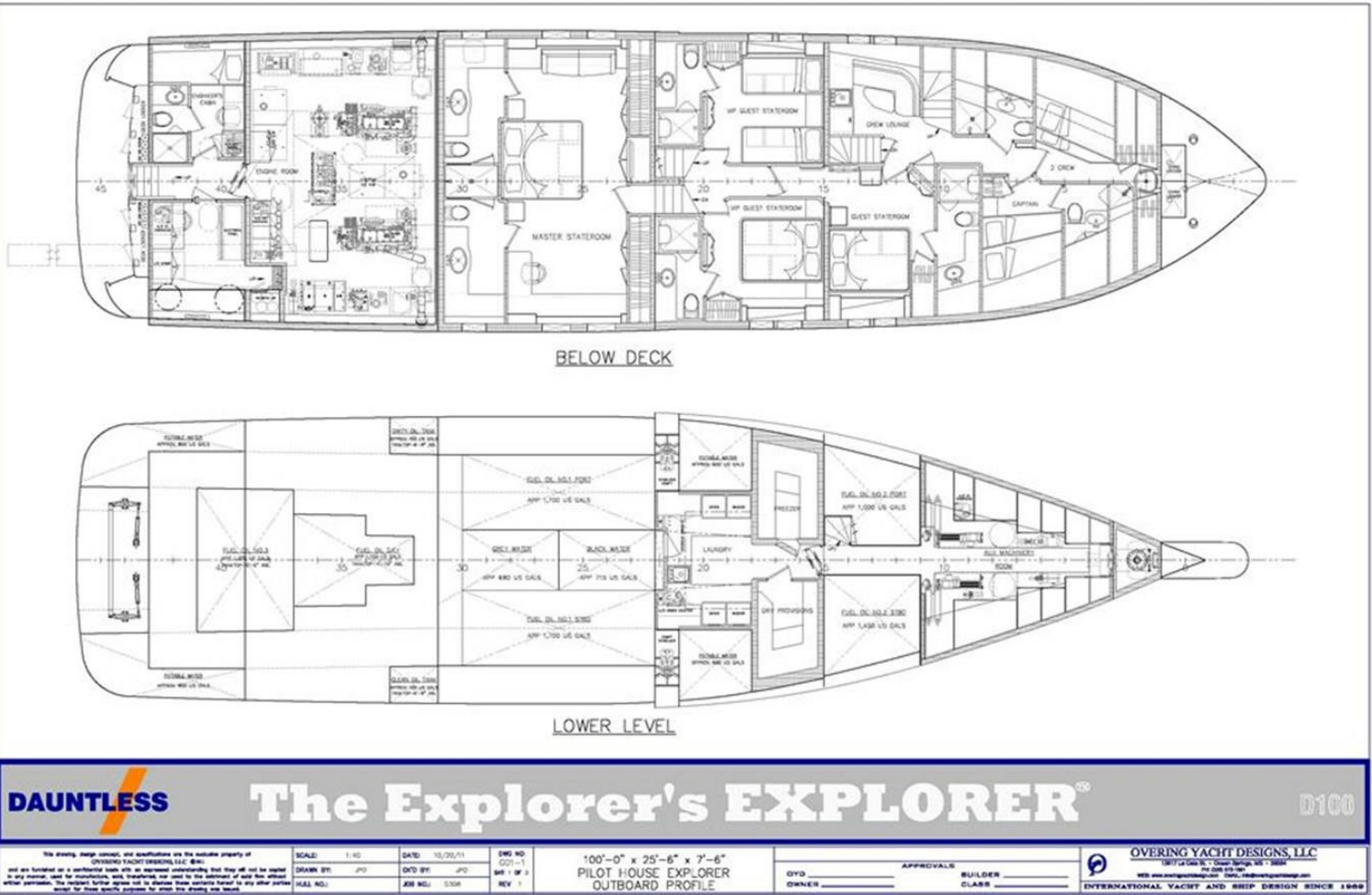

Generated On 5/9/2025 5:27 AM by WORLD YACHT GROUP SVC Account