



VERPEKA DOLLING
SUPERYACHTS

Grace



LOA:	91' 11" (28m)	Delivery/Model	2013
Beam:	23' 9" (7.23m)	Year:	
Tonnage:	169.00	Model:	Yacht 28
Speed:	10 Knots 13 Knots	Builder:	AEGEAN YACHT
Flag:	Croatian	Type:	Motor Yacht Displacement
Location:	Split, Split-Dalmatia Croatia	Staterooms:	5
VAT Paid:	VAT Unpaid	Fuel Cap:	14000 L (3698.41 Gal)
		Water Cap:	3300 L (871.77 Gal)
		Engines:	2x, Yanmar, 6HYM- WET, 515 HP
		Price:	(\$2,826,394 USD est.) €2,600,000 EUR

Generated On 5/20/2024 3:03 AM by VERPEKA DOLLING Yacht Brokerage SVC Account

VERPEKA DOLLING
Superyachts

VERPEKA DOLLING Yacht
Brokerage SVC Account
info261020210200@verpeka-
dolling-yacht-brokerage.com
www.verpeka.com

Grace

Additional Specifications For Grace:

LOA:	91' 11" (28m)	Delivery/Model	2013
Beam:	23' 9" (7.23m)	Year:	
Min Draft:	5' (1.5m)	Year Built:	2013
Hull Material:	Steel	Refit Year:	2018
Superstructure:	Steel	Builder:	AEGEAN YACHT
Hull Config:	Full Displacement	Model:	Yacht 28
Hull Designer:	In house Aegean Yachts	Type:	Motor Yacht Displacement
Deck Material:	Teak	Engines:	515 HP, Twin, Inboard, Diesel/Electric, Yanmar, 6HYM- WET, 1714hrs / 1714hrs
Tonnage:	169.00	Staterooms:	5
Range At Cruise	800	Sleeps:	10
Speed:		Heads:	5
Range At Max	1400	Crew Berths:	4
Speed:	Cruising 10 Knots	Captain Cabin:	No
	Max 13 Knots	Classifications:	
Int Designer:	In house Aegean Yachts	MCA: No	ISM: No
Ext Designer:	In house Aegean Yachts		
Fuel Capacity:	14000 L (3698.41 Gal)		
Water Capacity:	3300 L (871.77 Gal)		
Holding Tank:	1000 L (264.17 Gal)		
Flag:	Croatian		
Location:	Split, Split-Dalmatia Croatia		
Price:	(\$2,826,394 USD est.) €2,600,000 EUR		
Tax Status:	VAT Unpaid		

GRACE DETAILS

Grace is a 28-meter-long motor yacht built in 2013 by Aegean Yachts. Afterward, this modern yacht started her first charter season, immediately upon extensive refit in 2018. She is perfect for families and at the same time great value for money.

The luxury yacht Grace has an extremely spacious layout for a yacht of her size. The upper deck has a charming lounge area on the aft and also a retractable bimini for shade. Besides, sunbathing area on the foredeck is spacious and enriched with alluring cushions. Al-fresco dining located on the aft main deck can elegantly host 10 guests. Additionally, the swimming platform laid with teak is a great sea 'vestibule'.

The motor yacht Grace features an amazing and wide salon with panoramic windows allowing a bright and voluminous feel throughout. Above all, the functional layout provides both cozy and dynamic areas for the guests to socialize and relax. The versatile layout of the cabins can accommodate 10 guests. Actually, this Aegean Yacht features five elegantly designed cabins, 3 Double and 2 Twin. All cabins are with en-suite facilities providing all the comfort and amenities of a five-star hotel.

GRACE running



GRACE aft sundeck

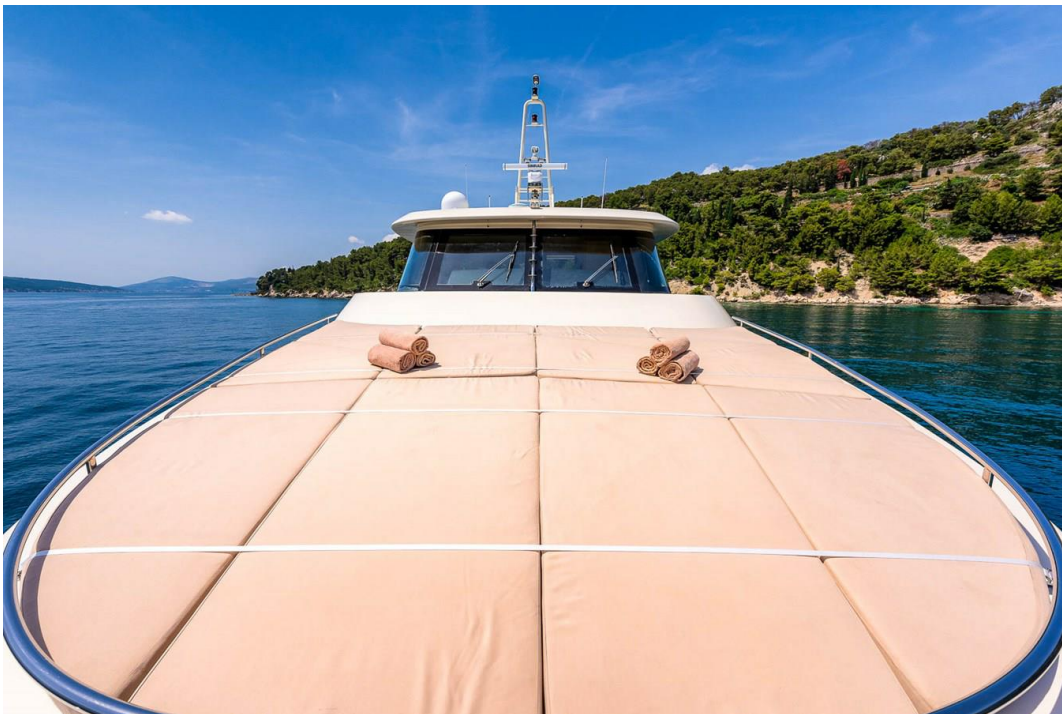

GRACE flybridge



GRACE al-fresco table details



GRACE main deck salon



GRACE master cabin other view



GRACE master cabin bathroom



GRACE lower deck double cabin



GRACE twin cabin



GRACE twin cabin



GRACE food



Generated On 5/20/2024 3:03 AM by VERPEKA DOLLING Yacht Brokerage SVC Account

VERPEKA DOLLING
Superyachts

VERPEKA DOLLING Yacht
Brokerage SVC Account
info261020210200@verpeka-
dolling-yacht-brokerage.com
www.verpeka.com

Grace

Page 9 of 11

GRACE layout 1

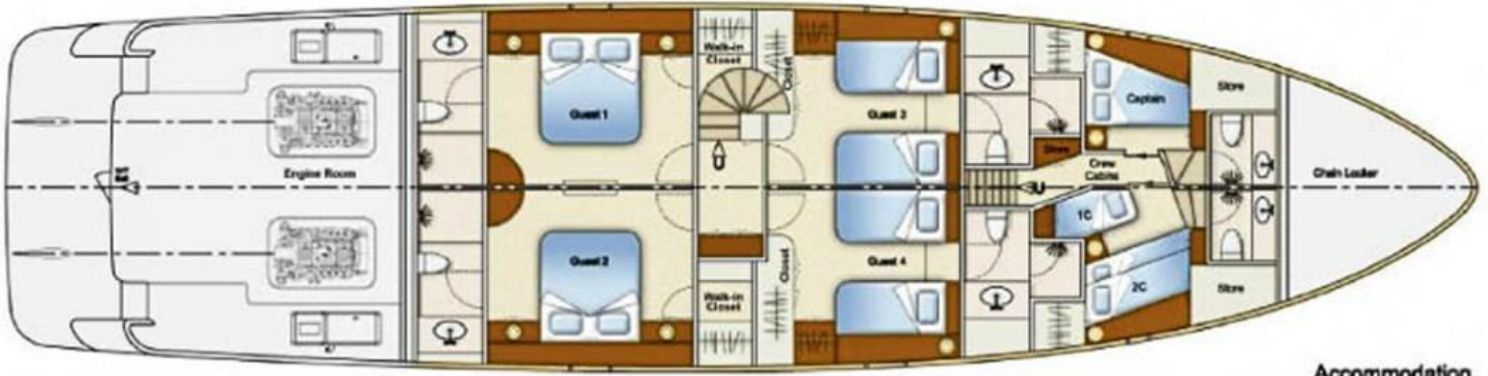

Accommodation



Main Deck



Sun Deck

Generated On 5/20/2024 3:03 AM by VERPEKA DOLLING Yacht Brokerage SVC Account

VERPEKA DOLLING
Superyachts

VERPEKA DOLLING Yacht
Brokerage SVC Account
info261020210200@verpeka-
dolling-yacht-brokerage.com
www.verpeka.com

Grace

Page 10 of 11

GRACE layout 2

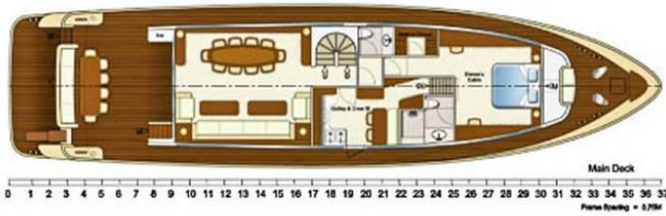
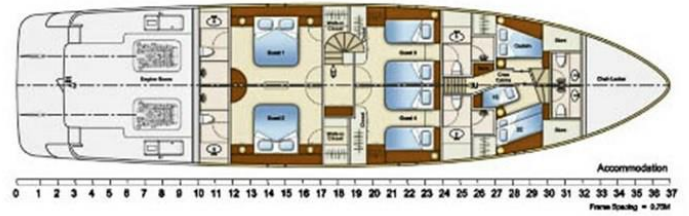

Generated On 5/20/2024 3:03 AM by VERPEKA DOLLING Yacht Brokerage SVC Account

VERPEKA DOLLING
Superyachts

VERPEKA DOLLING Yacht
Brokerage SVC Account
info261020210200@verpeka-
dolling-yacht-brokerage.com
www.verpeka.com

Grace

Page 11 of 11