



Type	Motor Yacht	Classification	--
Top	--	Class Type	--
Model	SX76	Builder	SANLORENZO YACHTS
Manuf. Year	2021	Naval Architect	Zuccon International Project
Refit Year	--	Interior Design	Piero Lissoni
LOA	76' (23.16m)	Hull	GRP
Beam	20' 10" (6.35m)	Deck	Teak
Draft Min/Max	1' 7" (0.48m) / 1' 7" (0.48m)	Engines	2x, Volvo Penta, IPS 1050, 800 HP
GRT	--	Max Speed	32 Knots
Fuel	5000 L (1320.86 Gal)	Cruise Speed	22 Knots
Water	1300 L (343.42 Gal)	Range	375
Flag	--	Accommodations	8 in 4 strms 2 crew

ASKING PRICE: (\$4,499,879 USD est.)
€3,900,000 EUR













Extras Screens on Bridge



SX
76/

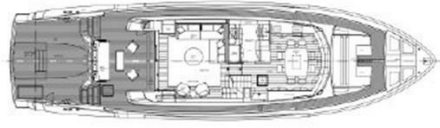

15. Decked or un-decked plan

Plan 004

SX
76/



16. Decked or un-decked plan

Plan 004

